

**BLOCK NO. 47**

**街 区 計 算**



# 面積計算書

工区

3

ブロック

47

計算者



精算者



備考

全体

点	①	②	③	④	⑤	⑥	③ × ⑤	② × ⑥
	X	X-(定数)	X <sub>n-1</sub> -X <sub>n+1</sub>	Y	Y-(定数)	Y <sub>n-1</sub> -Y <sub>n+1</sub>		
I	-152,489.728	-152.450 39.728 = + 38.011	-37,799.133	-37.790 9.133 = + 139.481			347.154463	5541.201168
II	-152,495.567	45.567 = + 6.106	-37,800.029	10.027 = + 1.770			61.224862	80.653590
III	-152,495.834	45.834 = + 2.776	-37,800.903	10.903 = + 53.064			30.266728	2429.385336
IV	-152,498.343	48.343 = + 3.621	-37,843.031	63.031 = + 86.419			228.235251	4177.753717
V	-152,499.455	49.455 = + 1.249	-37,887.322	97.322 = + 51.048			121.555178	2524.578860
VI	-152,499.592	49.592 = + 2.199	-37,904.079	114.079 = + 44.746			250.859721	2219.063632
VII	-152,501.654	51.654 = + 1.684	-37,922.068	142.068 = + 45.428			239.242512	2346.537912
VIII	-152,501.276	51.276 = - 44.098	-37,909.507	159.507 = + 7.440			7033.939866	381.493440
IX	-152,457.556	7.556 = - 11.548	-37,939.508	149.508 = - 130.374			1726.518384	1136.225944
							8760.438076	1278.538715
							6667.527112	14159.446467
							7481.919355	7481.919355
							Y <sub>2</sub> = 3740.959648	
							ΣⅧ ΣⅨ ΣⅩ	
							3740.95 <sup>m2</sup> - 1.96 - 4.50 - 2.0 = 3.732.49 <sup>m2</sup> + 186.25 = 3918.71 <sup>m2</sup>	
							178.25 = 3910.74	

# 面地計算

B.NO 47

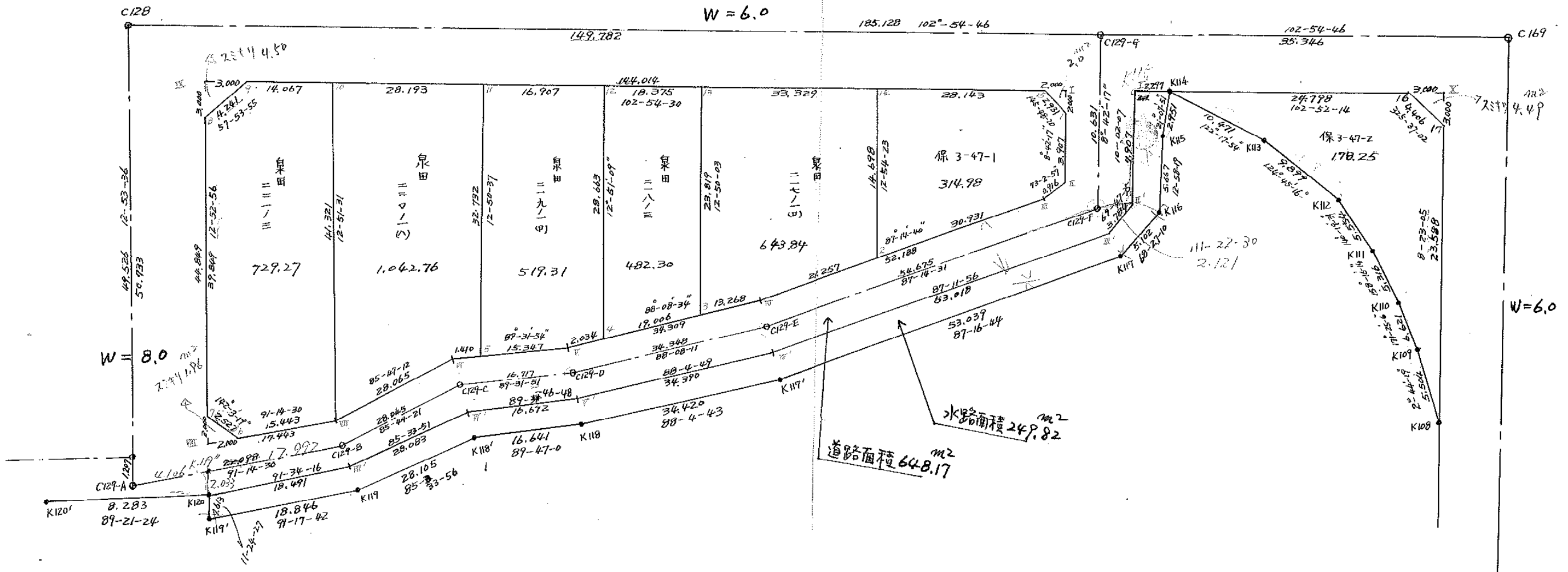

面積計算書

工区

3

ブロック

47

計算者



精算者



備考

泉田 22103

点	①	②	③	④	⑤	⑥	③ × ⑤		② × ⑥	
	X	X-(定数)	X <sub>n-1</sub> -X <sub>n+1</sub>	Y	Y-(定数)	Y <sub>n-1</sub> -Y <sub>n+1</sub>	+	-	+	-
8	-152,460.480	<sup>-152,450</sup> 10.480	-41.100	-37,440.177	<sup>-37,420</sup> 20.177	-12.977	824.274700		130.758460	
9	-152,458.226	8.226	+0.884	-37,436.584	16.584	-17.305		14.743176	142.350430	
10	-152,461.364	11.364	+43.928	-37,422.872	2.872	-4.516		124.725216	51.392404	
11	-152,501.654	51.654	+34.450	-37,432.068	12.068	+24.635		482.116600		1272.446240
6	-152,501.314	51.314	-2.328	-37,447.507	27.507	+16.443	64.036246			872.063767
7	-152,444.326	44.326	-40.834	-37,444.061	24.061	-7.330	1186.822174		361.544580	
							2080.133175		621.584442	686.011874
										2144.560057
							1458.548183			1458.548183
							$\frac{1}{2} = 729.2740915$			

面積計算書						工区	ブロック	計測者	精算者	備考
						3	47			泉野 22001 (A) 泉野 21901 (B)
点	①	②	③	④	⑤	⑥	③ × ⑤		② × ⑥	
	X	X-(定数)	X <sub>n-1</sub> -X <sub>n+1</sub>	Y	Y-(定数)	Y <sub>n-1</sub> -Y <sub>n+1</sub>	+	-	+	-
10	-152,461.369	<sup>-152.460</sup> 1.369	-33.987	-37,922.872	<sup>-37.890</sup> 32.872	-36.676	1117.220664		50.209444	
11	-152,467.667	7.667	+38.211	-37,895.392	5.392	-20.204		206.033712	154.904068	
V	-152,499.480	39.580	+31.925	-37,902.668	12.668	+8.687		404.425900		343.831460
VI	-152,499.492	39.592	+2.074	-37,904.079	14.079	+29.400		29.199846		1164.004800
VII	-152,501.654	41.654	-38.223	-37,922.068	42.068	+18.793	1607.765164			782.803622
							2725.185828	639.659458	205.173512	2290.639802
							2085.526370			2085.526370
							分筆後の座標なし			
							1/2 = 1042.763185			
11	-152,467.667	<sup>-152.460</sup> 7.667	-28.136	-37,895.392	<sup>-37.870</sup> 25.392	-23.756	714.429312		182.137252	
12	-152,471.444	11.444	+31.722	-37,878.912	8.912	-10.104		282.706464	115.630176	
4	-152,499.389	39.389	+28.011	-37,884.288	15.288	+8.410		428.232168		331.261490
V	-152,499.455	39.455	+0.191	-37,887.322	17.322	+17.380		3.308502		685.727900
5	-152,499.480	39.580	-31.788	-37,902.668	32.668	+8.070	1038.450384			319.410600
							1752.879696	714.247184	297.767428	1336.399990
							1038.632562			1038.632562
							1/2 = 519.316281			

面積計算書

工区

3

ブロック

47

計算者



精算者





備考

東區 21803  
東區 21791(10)

点	①	②	③	④	⑤	⑥	③ × ⑤		② × ⑥	
	X	X-(定数)	X <sub>n-1</sub> -X <sub>n+1</sub>	Y	Y-(定数)	Y <sub>n-1</sub> -Y <sub>n+1</sub>	+	-	+	-
12	-152,471.444	-152,400 -71.444	-23.840	-37,878.912	-37,800 -78.912	-24.287	1881.262080		1735.160428	
13	-152,475.449	-75.549	+27.329	-37,861.001	-61.001	-12.620		1667.076329	953.428380	
3	-152,498.773	-98.773	+23.840	-37,866.292	-66.292	+24.287		1580.40280	2398.89985	
4	-152,499.389	-99.389	-27.329	-37,884.288	-85.288	+12.620	2330.835752		1254.289180	
							4212.097832	3247.497609	2688.58808	3653.189031
							914.600223			964.600223
								1/2 = 482.300112		
13	-152,475.449	-152,400 -75.549	-15.779	-37,861.001	-37,800 -61.001	-37.777	962.534777		2854.014573	
14	-152,482.994	-82.994	+21.772	-37,828.415	-28.515	-24.203		620.828580	2423.673782	
2	-152,497.321	-97.321	+15.349	-37,831.798	-31.798	+24.516		488.067502	2385.921636	
IV	-152,498.343	-98.343	+1.452	-37,843.031	-53.031	+34.499		77.001012	3392.243442	
3	-152,498.773	-98.773	-22.779	-37,846.292	-66.292	+7.970	1511.059848		787.220810	
							2473.54627	1185.897094	5277.688255	6565.385888
							1287.617533			1287.617533
								1/2 = 643.848766		





面積計算書		工区	3	ブロック	47	計算者		精算者		備考		
点	①	②	③	④	⑤	⑥	③	×	⑤	②	×	⑥
	X	X-(定数)	X <sub>n-1</sub> -X <sub>n+1</sub>	Y	Y-(定数)	Y <sub>n-1</sub> -Y <sub>n+1</sub>	+		-	+		-
Ⅷ	-152,459.556	-152,400 -57.556	-2.254	-37,939.508	-37,900 -39.508	-3.593	89.051032			206.798708		
9	-152,458.226	-58.226	+2.924	-37,936.584	-36.584	+0.669		106.971616				38.953194
8	-152,460.480	-60.480	-0.670	-37,940.177	-40.177	+2.924	26.918590					176.843520
							115.969622	106.971616		206.798708		215.796714
							8.998006					8.998006
									1/2 = 4.499003			
Ⅰ	-152,489.728	-152,400 -89.728	+2.424	-37,799.133	-37,000 -799.133	-1.647		1937.098392		147.782016		
1	-152,491.705	-91.705	-0.447	-37,799.436	-799.436	+1.950	357.347892					178.824750
15	-152,489.281	-89.281	-1.977	-37,801.083	-801.083	-0.303	1583.741091			27.052143		
							1941.088983	1937.098392		174.834159		178.824750
							3.990591					3.990591
									1/2 = 1.9952955			

面積計算書						工区	ブロック	計算者	精算者	備考
						3	47			保 3-47-2
点	①	②	③	④	⑤	⑥	⑦	⑧	⑨	⑩
	X	X-(定数)	X <sub>n-1</sub> -X <sub>n+1</sub>	Y	Y-(定数)	Y <sub>n-1</sub> -Y <sub>n+1</sub>	+	-	+	-
17	-152.500.376	-152.400 100.376	+ 26.972	-37.766.083	-37.700 66.083	+ 0.952			1782.390676	95.557952
K.108	-152.523.712	123.712	+ 17.838	-37.769.523	69.523	+ <del>3.177</del> + 37.997			1240.151274	393.033024
K.109	-152.518.214	118.214	- 12.045	-37.769.260	69.260	+ 0.725	834.236700			85.705150
K.110	-152.511.687	111.687	- 11.425	-37.770.248	70.248	+ 2.956	806.798280			330.027652
K.111	-152.506.729	106.729	- 9.213	-37.772.216	72.216	+ 5.514	665.326000			528.503706
K.112	-152.502.454	102.454	- 9.918	-37.775.762	75.762	+ 11.679	751.407516			1,196.560266
K.113	-152.496.811	96.811	- 11.738	-37.783.895	83.895	+ 16.984	942.812010			1,644.238024
K.114	-152.491.216	91.216	- 0.071	-37.792.746	92.746	- 15.324	6.584966		1397.793984	
16	-152.496.740	96.740	+ 9.160	-37.763.571	68.571	- 26.663			628.110360	2579.378620
									4007.165480	3650.652310
									3977.172604	4333.625774
									356.513170	356.513170
										$\frac{1}{2} = 178.256585$

# 面積計算書

工区

3

ブロック

47

計算者



精算者



備考

隅切 五

点	①	②	③	④	⑤	⑥	③	×	⑤	②	×	⑥
	X	X-(定数)	X <sub>n-1</sub> -X <sub>n+1</sub>	Y	Y-(定数)	Y <sub>n-1</sub> -Y <sub>n+1</sub>	+		-	+		-
五	-152,497.408	<sup>-152,490</sup> 7.408 =	+3.626 =	-37,765.646	<sup>-37,760</sup> 5.646 =	-2.488 =				20,528,856	18,431,104	
17	-152,500.376	10.376 =	-0.668 =	-37,766.083	6.083 =	+2.725 =	4,063,444 =					30,347,800 =
16	-152,496.740	6.740 =	-2.768 =	-37,768.571	8.571 =	-0.427 =	25,438,728 =				2,745,380 =	
							27,502,172 =		20,528,856 =	27,376,484 =	30,347,800 =	
							8,773,316 =				8,773,316 =	
									1/2 = 4,486,658 =			

# 面積計算書

工区

3

ブロック

計算者



精算者



備考

水路 (地内=追加分)

点	①	②	③	④	⑤	⑥	③	×	⑤	②	×	⑥
	X	X-(定数)	X <sub>n-1</sub> -X <sub>n+1</sub>	Y	Y-(定数)	Y <sub>n-1</sub> -Y <sub>n+1</sub>	+	-	+	-	+	-
K114	-152 491.216	=-152.490 1.216	+ 3.270	-37 792.746	=-37.790 2.746	- 1.174						
K115	493.969	3.969	+ 8.275	793.810	3.810	+ 2.336						
K116	499.491	9.491	+ 7.396	795.082	5.082	+ 6.018						
K117	501.365	11.365	+ 4.392	799.828	9.828	+ 57.725						
K117'	503.883	13.883	+ 3.672	852.807	62.807	+ 87.380						
K118	505.037	15.037	+ 1.217	887.208	97.208	+ 51.042						
K118'	505.100	15.100	+ 2.236	903.849	113.849	+ 44.662						
K119	507.273	17.273	+ 1.747	931.870	141.870	+ 46.864						
K119'	506.847	16.847	- 2.007	950.713	160.713	+ 18.524						
K120	505.266	15.266	- 1.074	950.394	160.394	- 18.803						
VII'	505.773	15.773	- 1.665	931.910	141.910	- 46.483						
VI'	503.601	13.601	- 2.236	903.911	113.911	- 44.671						
V'	503.537	13.537	- 1.217	887.239	97.239	- 51.043						
IV'	502.384	12.384	- 3.744	852.868	62.868	- 87.326						
III'	499.793	9.793	- 3.898	799.913	9.913	- 56.506						
II'	498.486	8.486	- 9.094	796.362	6.362	- 4.929						
I'	490.699	0.699	- 7.270	794.984	4.984	- 3.616						

1472.247530 972.60091 23999.353423 4479.00004

499.646618 499.646618

1/2 = 249.823309

# 面積計算書

工区

3

ブロック

計算者



積算者



備考

通路 11号

点	①	②	③	④	⑤	⑥	③	×	⑤	②	×	⑥
	X	X-(定数)	X <sub>n-1</sub> -X <sub>n+1</sub>	Y	Y-(定数)	Y <sub>n-1</sub> -Y <sub>n+1</sub>	+		-	+		-
I'	-152 490.699	-152.480 10.699	+8.758	-37. 794.984	-37.770 4.884	-2.771				43.64872		21.64622
II'	498.486	18.486	+9.094	796.362	6.362	+4.929				57.856028		11.117494
III'	499.793	19.793	+3.898	799.913	9.913	+56.506				38.690874		1118.423258
IV'	502.384	22.384	+3.744	852.868	62.868	+87.326				235.377792		1759.705184
V'	503.537	23.537	+1.217	887.239	97.239	+51.043				118.339863		1201.399091
VI'	503.601	23.601	+2.236	903.911	113.911	+44.671				254.704996		1059.280271
VII'	505.773	25.773	+1.665	931.910	141.910	+46.483				236.280150		1198.006359
K120	505.266	25.266	-4.497	950.394	110.394	+17.597				721.291818		444.605802
VIII	501.276	21.276	-3.612	949.507	159.507	-18.326				576.139284		389.903976
IX	501.654	21.654	-1.684	932.068	142.068	-45.428				239.292512		983.697912
X	499.592	19.592	-2.199	904.079	114.079	-44.746				250.859721		876.663632
XI	499.455	19.455	-1.249	887.322	97.322	-51.048				121.555178		993.138840
XII	498.343	18.343	-3.621	853.031	63.031	-86.419				228.235259		1585.183717
XIII	495.834	15.834	-2.776	800.903	10.903	-53.004				30.266728		839.265336
XIV	495.567	15.567	-6.106	800.027	10.027	-1.770				61.224862		27.553590
XV	489.728	9.728	-4.868	799.133	9.133	-5.043				44.459444		49.058304

$\frac{1}{2} = 644.2126115$

$644.21 + 2.0 = 648.17$

$2273.274798 + 89.899575 = 2363.174374$   
 $1288.425223$

$7062.537951$   
 $1288.425223$

計年  
月  
算日

計  
算  
者

檢  
查  
者

B.NO. 47

各筆面積計算書

地番	算式	隅切	地積	摘	要
	泉田 221-3		729.27		
	泉田 220-1 (1)		1,042.76		
	泉田 219-1 (1)		519.31		
	泉田 218-3		482.30		
	泉田 217-1 (1)		643.84		
	保 3-47-1		314.98		
	計		3,732.46		
	(全体) 但し西側のみ		3,732.49		差 0.03
	保 3-47-2 (東側のみ)		178.25		
	換地		3,417.48		
	保留地		493.20		
	計		3,910.71		