

BLOCK NO. 50

街 区 計 算

街区略図

工区

ヨ

ブロック

~~26~~ 50

記入者



点検者



$X = -152.228.037$

$Y = -37.841.068$

$W = 8.000$

$X = -152.277.830$

$Y = -37.673.688$



$W = 8.000$

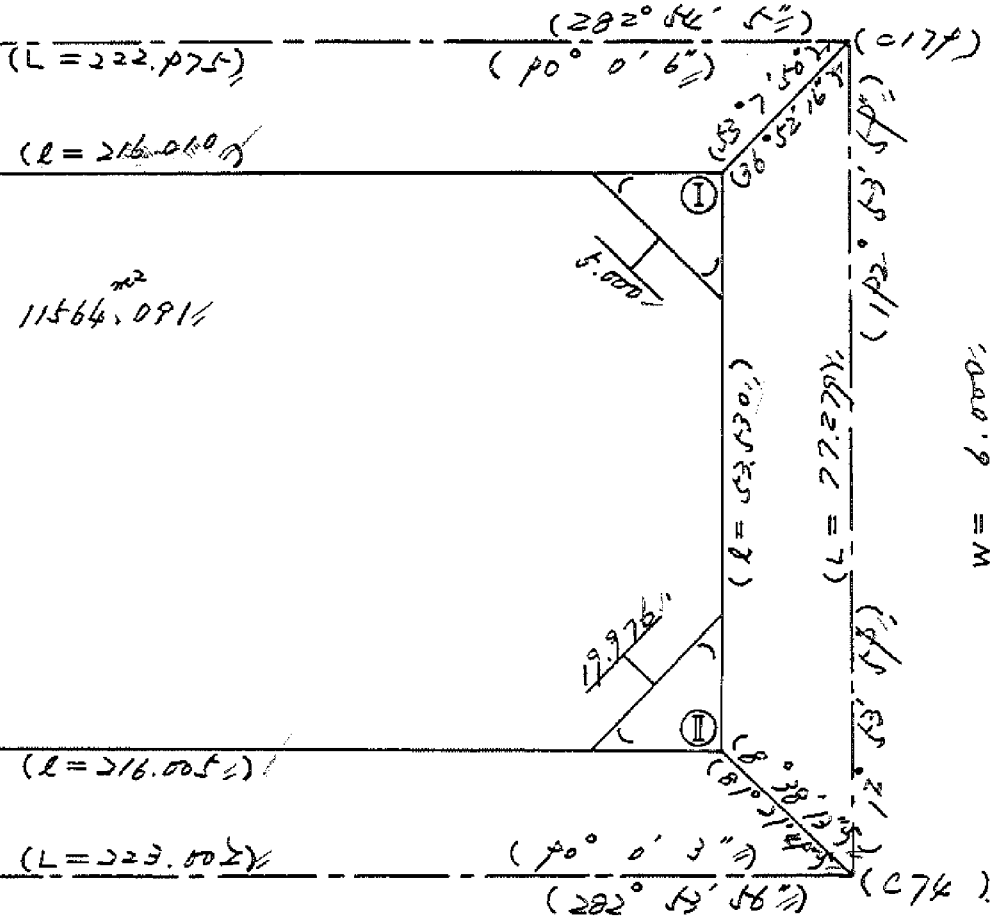
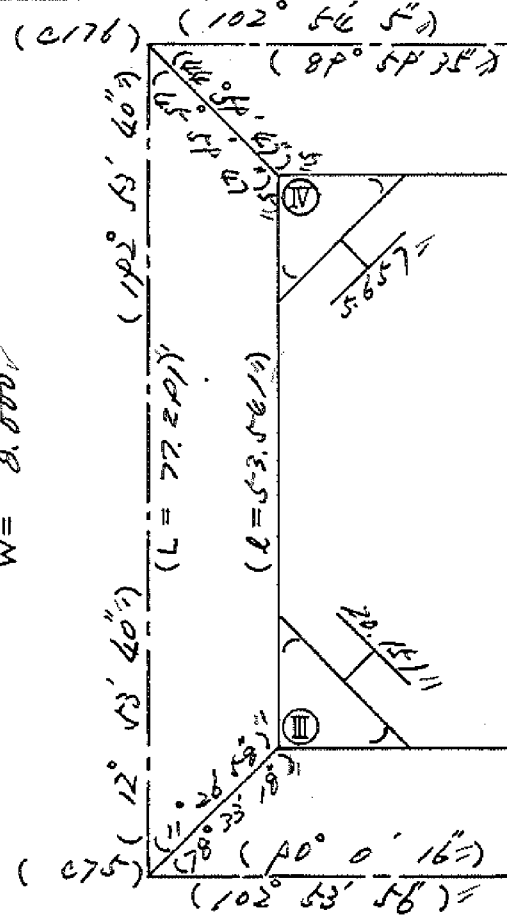

11564.091^{m2}

$X = -152.303.379$

$Y = -37.808.316$

$W = 39.500$

$X = -152.353.159$

$Y = -37.640.441$

圖地計算

面積計算書

工区 W ブロック 50 計算者 精算者 備考 青江 661-1
" 557-1

点	①	②	③	④	⑤	⑥	③ × ⑤		② × ⑥	
	X	X-(定数)	X _{n-1} -X _{n+1}	Y	Y-(定数)	Y _{n-1} -Y _{n+1}	+	-	+	-
1	-152,223.783	-152.200 83.993	+20.259	-37.672.175	-37.600 78.175	+1.562		1583.747325		121.181446
2	-152,200.648	100.648	+2.613	-37.601.792	81.792	+65.163		214.245076		6556.512664
3	-152,226.576	96.576	-33.633	-37.743.318	143.318	+55.827	4820.214296			4920.990872
30	-152,267.015	67.015	-6.207	-37.728.219	138.819	-62.888	861.649533		4214.439320	
31	-152,280.389	80.389	+16.968	-37,680.430	80.430	-60.664		1364.736260	4870.110516	
							5681.943827	312.728661	9089.549836	11608.685002
							2519.135166			2519.135166
							$\frac{1}{2} = 1259.567583$			
2	-152,300.648	-152.200 100.648	+30.589	-37.681.792	-37.600 81.792	-22.781		2508.053288	2312.991680	
3	-152,324.707	124.707	+30.637	-37.687.502	87.502	+15.993		2680.788776		1994.471027
4	-152,331.285	131.285	+1.999	-37.697.985	97.985	+30.467		195.872015		3999.860095
5	-152,326.708	126.708	-37.165	-37.717.969	117.969	+12.498	4386.317885			1583.595584
32	-152,294.120	94.120	-26.060	-37.710.483	110.483	-35.977	2879.186980		3386.155240	
							7263.504865	5386.726077	5699.146828	7577.927716
							1878.780788			1878.780788
							$\frac{1}{2} = 939.390394$			

面積計算書		工区	ブロック	50	計算者	精算者	備考	青江 560-1(0)		
		3						" 560-1(1)		
点	①	②	③	④	⑤	⑥	③ × ⑤	② × ⑥		
	X	X-(定数)	X _{n-1} -X _{n+1}	Y	Y-(定数)	Y _{n-1} -Y _{n+1}	+ -	+ -		
32	-152, 294.120	-152, 280 14.120	+ 40.112	-37, 710.483	- 37.700 10.483	- 25.349		420.494096	357.927890	
f	-152, 326.708	46.708	+ 25.068	-37, 717.969	17.969	+ 40.323		450.446892	1983.406.684	
6	-152, 319.188	39.188	- 40.112	-37, 750.806	50.806	+ 25.349	2037.930272		993.376.612	
33	-152, 286.596	6.596	- 25.068	-37, 743.318	43.318	- 40.323	1025.295624	265.970508		
							3123.225896	870.940988	623.894388	2276.783256
							2252.884908			2252.884908
								1/2 = 1126.442454		
8	-152, 318.407	-152, 260 58.407	+ 49.808	-37, 754.218	- 37.740 14.218	+ 22.318		708.170144	1303.527426	
9	-152, 316.041	56.041	- 54.551	-37, 764.549	24.549	- 1.610	1339.172499	90.226010		
27	-152, 263.856	3.856	- 49.808	-37, 752.608	12.608	- 22.318	627.979264	86.058208		
28	-152, 266.233	6.233	+ 54.551	-37, 742.231	8.231	+ 1.610		121.703281	10.025130	
							1967.151763	229.873424	176.284218	1313.562556
							1137.278338			1137.278338
								1/2 = 568.639169		

面積計算書

工区

ウ

ブロック

7-50

計算者



精算者



備考

市工 556-1(N)
" 555-1

点	①	②	③	④	⑤	⑥	③ × ⑤		② × ⑥	
	X	X-(定数)	X _{n-1} -X _{n+1}	Y	Y-(定数)	Y _{n-1} -Y _{n+1}	+	-	+	-
P	-152.307.041	-152.200 116.061	+45.713	-37.784.547	-37.789 66.549	+42.204			2950.728.437	4665.312.364
10	-152.307.567	109.569	-58.660	-37.772.812	92.812	+16.328	5444.251920			1789.042.632
26	-152.257.381	57.381	-45.713	-37.780.877	80.877	-40.204	3697.130.301			2306.965.724
27	-152.263.856	63.856	+58.660	-37.752.608	52.608	-16.328			3085.985.280	1942.640.768
							9141.482.221	6036.713.717	3349.586.492	6654.354.996
							3106.768.506			3106.768.506
							$\frac{1}{2} = 1552.384252$			
10	-152.307.567	-152.200 109.569	+50.201	-37.772.812	-37.789 92.812	+20.612			4659.255.212	2258.436.228
11	-152.307.582	107.582	-54.175	-37.801.487	101.489	-3.260	5498.106.577		350.717.320	
24	-152.255.374	55.374	-50.201	-37.787.552	89.552	-20.612	4497.599.252		1141.781.128	
26	-152.257.381	57.381	+54.175	-37.780.877	80.877	+3.260			4381.511.477	187.062.060
							9993.766.527	9040.216.687	1492.478.448	2445.498.288
							952.998.400			952.998.400
							$\frac{1}{2} = 476.499.200$			

面積計算書							工区	ウ	ブロック	50	計測者	精算者	備考	泉田	214(口)
点	①	②	③	④	⑤	⑥	③ × ⑤		② × ⑥						
	X	X-(定数)	X _{n-1} -X _{n+1}	Y	Y-(定数)	Y _{n-1} -Y _{n+1}	+	-	+	-					
11	-152,307.582	-152.200 107.582	+51.072	-37,801.489	-37.700 101.489	+16.811		5183.246208		1508.561002					
12	-152,306.466	106.466	-53.305	-37,806.363	106.363	-7.063	5669.679715		751.969358						
24	-152,254.277	54.277	-51.072	-37,794.426	94.426	-16.811	4822.524672		912.450547						
25	-152,255.394	55.394	+53.305	-37,789.552	89.552	+7.063	4773.569360		391.247822						
							10492.204387	9956.815568	1064.420005	2199.808824					
							535.388819			535.388819					
							1/2 = 267.6944095								
12	-152,306.466	-152.200 106.466	+48.184	-37,806.363	-37.700 106.363	+29.422		5124.994792		3132.442652					
13	-152,302.461	102.461	-25.246	-37,823.848	123.848	+12.632	3126.666608		1294.297352						
35	-152,281.220	81.220	-20.340	-37,818.995	118.995	-8.794	2420.358300		713.436480						
34	-152,282.121	82.121	-30.046	-37,815.064	115.064	-11.020	3457.212944		904.973420						
23	-152,251.174	51.174	-27.864	-37,807.975	107.975	-20.638	3006.455900		1056.129012						
24	-152,254.277	54.277	+55.292	-37,794.426	94.426	-1.612		5221.002392	87.494524						
							12010.693752	10345.997184	2762.033436	4426.730004					
							1664.696568			1664.696568					
							1/2 = 832.348284								

面積計算書						工区	ブロック	計算者	備考	番江	551-1	552-1
点	①	②	③	④	⑤	⑥	③ × ⑤	② × ⑥				
	X	X-(定数)	X _{n-1} -X _{n+1}	Y	Y-(定数)	Y _{n-1} -Y _{n+1}	+	-	+	-		
25	-152, 281.220	-152.200 81.220	+ 25.871	-37, 818.795	-37.800 18.795	-15.353		491, 419.665	1246, 970.660			
13	-152, 202.461	102, 461	+ 16.616	-37, 823.848	23, 848	+ 25.061		395, 210.572			2567.775121	
13'	-152, 297.834	97, 834	- 25.871	-37, 844.056	44, 056	+ 15.353	1139.772.776				1502.065402	
26	-152, 276.590	76, 590	- 16.614	-37, 829.201	39, 201	- 25.061	651.285.414		1919.421990			
							1791.058190	807.630317	3166.392650	4069.820523		
							903.427.873			903.427.873		
							1/2 = 451.7139365					
26'	-152, 276.590	-152.200 76.590	+ 25.874	-37, 829.201	-37.800 39, 201	- 15.349		1014, 286.676	1175, 579.910			
13'	-152, 297.834	97, 834	+ 16.616	-37, 844.056	44, 056	+ 25.063		732, 034.496			2452.013542	
14	-152, 293.206	93, 206	- 25.874	-37, 864.264	64, 264	+ 15.349	1662.766.736				1430.618.896	
27	-152, 271.960	71, 960	- 16.616	-37, 859.405	59, 405	- 25.063	987.073.680		1803.533480			
							2449.840216	1746.321170	2772.1123.90	3882.682436		
							903.519.046			903.519.046		
							1/2 = 451.759523					

面積計算書		工区	ブロック	計算者	精算者	備考	② × ⑤		② × ⑥	
点	① X	② X-(定数)	③ X _{n-1} -X _{n+1}	④ Y	⑤ Y-(定数)	⑥ Y _{n-1} -Y _{n+1}	+	-	+	-
		-152.230			-37.850					
21	-152, 241.014	11.014	+ 56.144	-37, 852.328	2.328	- 5.319		130.703232	58.583466	
14	-152, 273.206	63.206	+ 48.239	-37, 264.264	14.264	+ 29.199		688.081096		1845.551994
15	-152, 287.253	59.253	- 56.144	-37, 881.527	31.527	+ 5.319	1770.051888			315.166707
20	-152, 237.062	7.062	- 48.239	-37, 869.583	19.583	- 29.199	944.664337		206.203338	
							2714.716225	818.784328	264.786804	2160.718701
							1892.931897			1892.931897
							1/2 = 947.96			
		-152.230			-37.860					
20	-152, 237.062	7.062	+ 55.754	-37, 869.583	9.583	- 3.611		534.290582	25.500882	
15	-152, 287.253	59.253	+ 49.911	-37, 881.527	21.527	+ 21.898		1074.434097		1297.522194
16	-152, 286.973	56.973	- 12.762	-37, 891.481	31.481	+ 16.530	401.760522			941.763690
17	-152, 276.491	46.491	- 51.220	-37, 898.057	38.057	- 2.750	1949.279540		127.850250	
18	-152, 235.753	5.753	- 42.992	-37, 888.731	28.731	- 12.919	1235.203152		74.323007	
19	-152, 233.499	3.499	+ 1.309	-37, 885.138	25.138	- 19.148		32.905642	66.998852	
							3586.243214	1641.630327	294.672991	2239.285884
							1944.612893			1944.612893
							1/2 = 972.30			

面積計算書

工区 3
 ブロック 50
 計算者 (Seal)
 精算者 (Seal)
 備考 青江 898, 899-4
 " 552-2

点	①	②	③	④	⑤	⑥	③ × ⑤		② × ⑥	
	X	X-(定数)	X _{n-1} -X _{n+1}	Y	Y-(定数)	Y _{n-1} -Y _{n+1}	+	-	+	-
15	-152, >89, >53	-152.240	+ 42.629	-37, 881.527	-37.870	+ 20.232				
		49.253			11.527		491.384483		996.486696	
16	>86.973	46.973	- 12.762	891.481	21.481	+ 16.530	274.140522		776.483690	
17	>76.491	36.491	- 46.862	898.057	28.057	- 1.752	1314.807134		63.932232	
39	240.111	0.111	- 32.147	889.729	19.729	- 26.808	134.228163		2975688	
38	244.344	4.344	+ 49.142	871.249	1.249	- 8.282	61.378358		35.629488	
							2223.175817		102.537408	
							1670.412978		1772.950386	
									1670.412978	
							1/2 = 835.206489		分筆後の座標なし	
19	-152, >33, >499	-152.230	+ 1.309	-37, 885.138	-37.860	- 19.148				
		3.499			25.138		32.905642		66.998852	
20	>37.062	7.062	+ 10.845	869.583	9.583	- 13.889	103.927635		98.084118	
38	244.344	14.344	+ 3.049	871.249	11.249	+ 20.146	34.298201		288.974224	
39	240.111	10.111	- 8.591	889.729	29.729	+ 17.482	255.401829		176.760502	
18	>35.753	5.753	- 6.612	888.731	28.731	- 4.591	189.969372		26.412023	
							445.371211		171.131478	
							191.494993		465.734725	
							274.239733		274.239733	
							1/2 = 137.1198225			

面積計算書										工区	ブロック	50	計算者	精算者	備考	54P	553-2			
点	①	②	③	④	⑤	⑥	③	×	⑤	②	×	⑤								
	X	X-(定数)	X _{n-1} -X _{n+1}	Y	Y-(定数)	Y _{n-1} -Y _{n+1}	+		-	+		-								
21	-152,241.014	-152.240 1.014	+25.944	-37.852.328	-37.830 22.328	+28.912							579.277632					29.316768		
37	-152,271.960	31.960	+35.948	-37.857.405	29.405	-14.752							1052.050940					471.473920		
36	-152,276.962	36.962	-25.944	-37.837.576	7.576	-28.912							196.551744					1068.645344		
22	-152,246.016	6.016	-35.948	-37.830.493	0.493	+14.752							17.722364					88.748032		
													214.274108					1540.119264	118.064800	
													1422.054464					1422.054464		
																			$\frac{1}{2} = 711.02$	
22	-152,246.016	-752.240 6.016	+25.788	-37.830.493	-37.800 30.493	+29.601							786.353484					178.079616		
36	-152,276.962	36.962	+36.105	-37.837.576	37.576	-15.429							1356.681480					570.286698		
34	-152,282.121	42.121	-25.788	-37.815.064	15.064	-29.601							388.470432					1246.823721		
23	-152,251.174	11.174	-36.105	-37.807.975	7.975	+15.429							287.937375					172.403646		
													676.407807					2143.034964	1817.110419	350.483262
													1466.627157					1466.627157		
																			$\frac{1}{2} = 73331$	

面積計算書		工区	ブロック	計算者	縮算者	備考	水路	
		ウ		450			小堤	
点	①	②	③	④	⑤	③ × ⑤	② × ⑥	
	X	X-(定数)	X _{n-1} -X _{n+1}	Y	Y-(定数)	+ -	+ -	
		-152.260			-37.730			
30	-152,267.015	7.015	-52.732	-37,732.819	8.819	-9.550	465.043508	66.993250
29	-152,266.456	6.456	+51.615	-37,741.256	11.256	+14.423	580.978440	93.114888
7	-152,318.630	58.630	+52.732	-37,753.242	23.242	+9.550	1225.597144	559.916500
6	-152,319.188	59.188	-51.615	-37,750.806	20.806	-14.423	1073.901690	853.668524
							1538.945198	1806.575584
							267.630386	267.630386
							1/2 = 133.81	
		-152.260			-37.740			
7	-152,318.630	58.630	+51.951	-37,753.242	13.242	+12.962	687.935142	759.962060
8	-152,318.407	58.407	-52.397	-37,754.218	14.218	-11.011	744.980546	643.119477
28	-152,266.233	6.233	-51.951	-37,744.231	2.231	+12.962	115.902681	80.792146
29	-152,266.456	6.456	+52.397	-37,741.256	1.256	+11.011	65.810632	71.087016
							860.883227	753.745774
							723.911623	831.049076
							107.137453	107.137453
							1/2 = 53.56	

面積計算書

工区

3

ブロック

450

計算者



精算者



備考

陽功

点	①	②	③	④	⑤	⑥	③ × ⑤		② × ⑥	
	X	X-(定数)	X _{n-1} -X _{n+1}	Y	Y-(定数)	Y _{n-1} -Y _{n+1}	+	-	+	-
		-152.280			-37.670					
I	152,281.054	1.059	+ 3.594	-37,677.505	7.505	- 2.255		26.972970	2,388.045	
1	152,283.983	3.983	- 0.670	-37,678.175	8.175	+ 2.925	5.477250			11.650275
2	152,280.384	0.389	- 2.924	-37,680.430	10.430	- 0.670	30.497320		0.260630	
							35.974570	26.972970	2,648.675	11.650275
							9.001600			9.001600
								1/2 = 4.50		
		-152.290			-37.680					
3	152,324.704	34.709	+ 1.953	-37,687.502	7.502	- 8.529		14.651406	296.033061	
II	152,333.238	43.238	+ 6.576	-37,688.656	9.456	+ 10.483		62.182656		453.263954
4	152,331.285	41.285	- 8.529	-37,697.985	17.985	- 1.954	153.394065		80.670890	
							153.394065	76.834062	376.703951	453.263954
							76.560003			76.560003
								1/2 = 38.28		

面積計算書		工区	ブロック	計算者	精算者	備考				
				450		陽功				
点	① X	② X-(定数)	③ X _{n-1} -X _{n+1}	④ Y	⑤ Y-(定数)	⑥ Y _{n-1} -Y _{n+1}	⑦ +	⑧ -	⑨ +	⑩ -
		-152.270			-37.890					
16	153,286.773	16.973	+ 8.529	-37.891.481	1.481	+ 1.953		12.631449		33.148269
Ⅲ	153,285.020	15.020	-10.482	-37.890.010	10.010	+ 6.576	104.924820			98.771520
17	153,276.491	6.491	+ 1.953	-37.898.057	8.057	- 8.529		15.735321	55.361739	
							104.924820	28.366770	55.361739	131.919789
							76.558050			76.558050
								1/2 = 38.27		
		-152.230			-37.880					
18	153,235.753	5.753	- 0.670	-37.888.731	8.731	+ 2.924	5.849770			16.821772
Ⅳ	153,232.829	2.829	- 2.254	-37.888.062	8.062	- 3.593	18.171748		10.164597	
19	153,233.499	3.499	+ 2.924	-37.885.128	5.138	+ 0.669		15.023512		2.340831
							24.021518	15.023512	10.164597	19.162603
							8.998006			8.998006
								1/2 = 4.49		

計年月日 46. 9. 16. 計算者 検査者

B.NO. ~~88~~50 各筆面積計算書

地番	算式	開	切	地積	摘	要
	青江 561 〇 1			1,259.56		
	青江 559 〇 1			939.39		
	青江 560 〇 1 (B)			1,126.44		
	青江 560 〇 1 (H)			568.63		
	青江 556 〇 1 (H)			1,552.38		
	青江 555 〇 1			476.49		
	泉田 214 (B)			267.69		
	青江 553 〇 1 (H)			832.34		
	青江 551 〇 1 } 552 〇 1			451.71		
	青江 552 〇 3			451.75		
	青江 548 (H)			947.96		
	青江 547 } 552-02			972.30	835.20 =	
					137.11 =	
	青江 549			711.02		
	青江 553 〇 2			733.31		
	水路			133.81		
	管理道			53.56		
	計			11,478.35		
	余休			11,478.53		
			差	-0.18		
	換地			11,290.98		
	水路			133.81		
	管理道			53.56		

