

BLOCK NO. 19-2

街区計算

街区略図

工区

2

ブロック

1P-2

記入者



点検者



$X = -152,517.831$

$Y = -36,400.309$

$W = 4,000$

$X = -152,618.617$

$Y = -36,287.886$

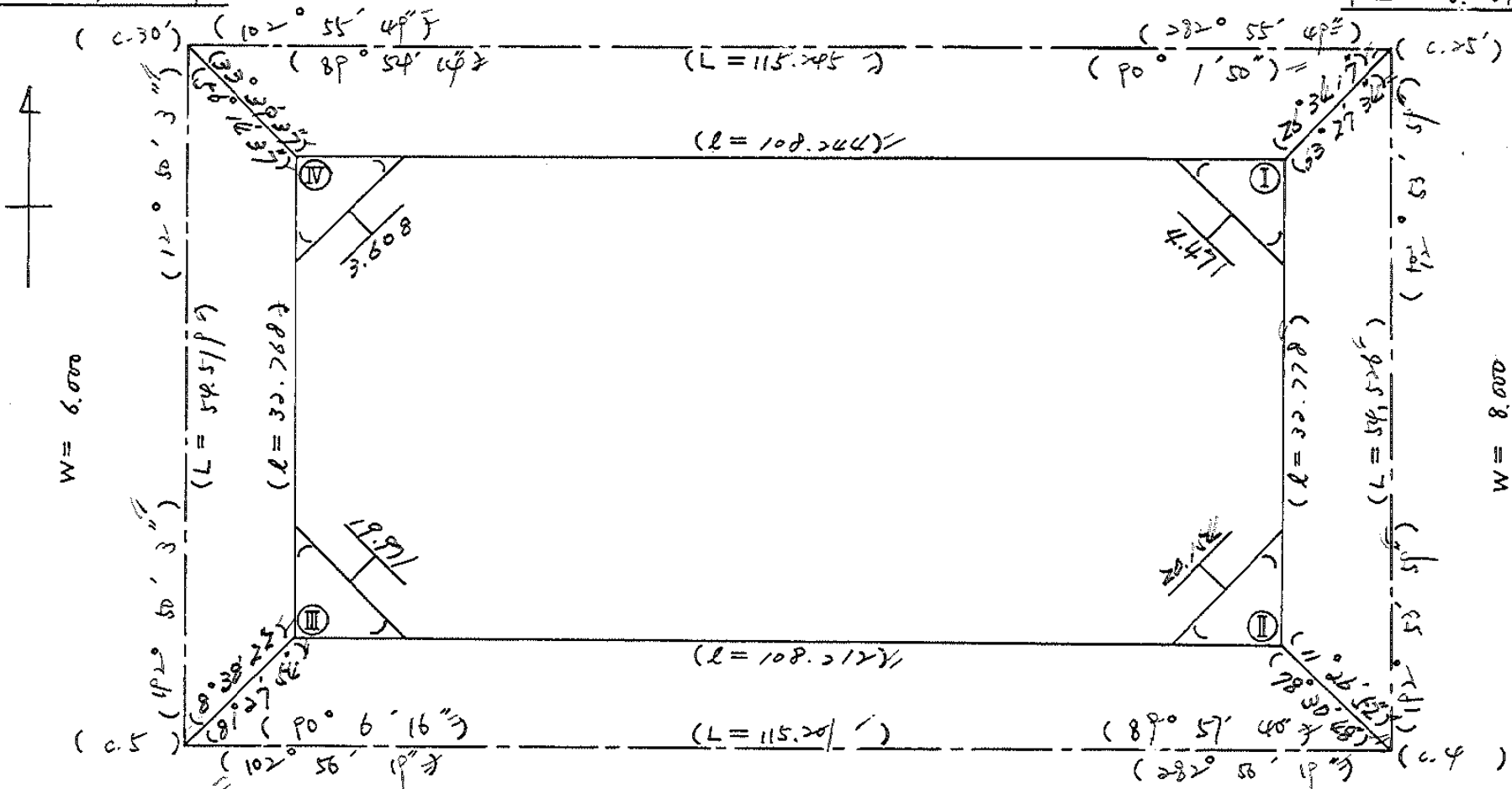

$X = -152,645.937$

$Y = -36,412.419$

$W = 39.500$

$X = -152,671.775$

$Y = -36,300.153$

面積計算書

工
区

Z

ブ
ロ
ック

19-2

計
算
者



精
算
者



備
考

全
体

点	①	②	③	④	⑤	⑥	③ × ⑤	② × ⑥		
	X	X-(定数)	X _{n-1} -X _{n+1}	Y	Y-(定数)	Y _{n-1} -Y _{n+1}	+	-		
I	-152,619.673	-152.500 119.673	+56.173	-36,392.331	-36.200 92.331	-98.188		5186.509263	11750.452524	
II	-152,641.625	151.625	+7.729	-36,399.642	99.642	+112.777		770.133018	17099.812625	
III	-152,627.402	127.402	-56.173	-36,404.108	205.108	+98.188	11521.531684		12509.347376	
IV	-152,644.452	95.452	-7.729	-36,397.830	197.830	-112.777	1529.028070		10714.790264	
							13050.559754	5956.642281	22515.242728	29609.160201
							7093.917473		7093.917473	
							1/2 = 3546.9587365			
			7区II II III IV 3546.95 = (2.00 + 38.28 + 38.28 + 2.00) = 8466.27							

画地計算

21区 1P-2

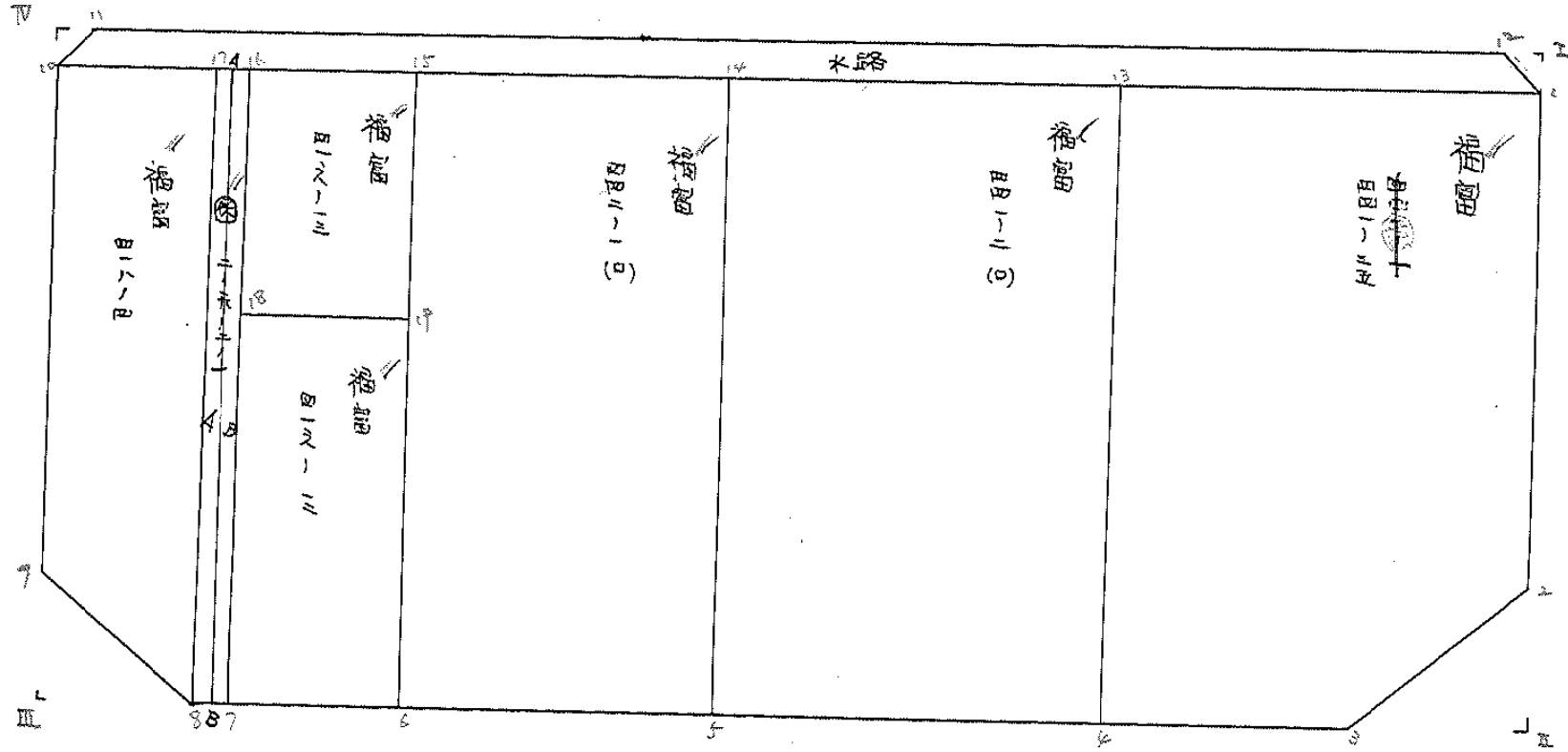

面積計算書						工区	2	ブロック	19-2	計算者	精算者	備考	福富 441-1 + 441-35	福富 441-2 (10)
点	①	②	③	④	⑤	⑥	③	⑤	②	⑥				
	X	X-(定数)	X _{n-1} -X _{n+1}	Y	Y-(定数)	Y _{n-1} -Y _{n+1}	+	-	+	-				
1	⁻¹⁵² 621.623	^{-152.610} 11.623	+27.612	⁻³⁶ 292.777	^{-36.290} 2.777	-21.826						76.678524	219.693598	
2	643.096	23.096	+29.043	297.690	7.690	+15.393						215.650670		509.446728
3	649.666	29.666	+2.386	308.170	18.170	+29.700						43.253620		1139.414200
4	645.482	25.482	-34.182	326.390	36.390	+11.346	1263.892980							402.578772
13	615.484	5.484	-23.859	319.516	29.516	-33.613	704.22244						184.333692	
							1938.105224					335.682814	438.017290	2050.439700
							1612.422410							1612.422410
							x ^{1/2} = 806.211205							
13	⁻¹⁵² 615.484	^{-152.600} 15.484	+37.653	⁻³⁶ 319.516	^{-36.300} 19.516	-26.466						734.835948	409.799544	
4	645.482	45.482	+22.341	326.390	26.390	+40.212						589.578990		1828922784
5	637.825	37.825	-37.653	359.728	59.728	+26.466	2248.938384							1001.076450
14	607.829	7.829	-22.341	352.856	52.856	-40.212	1180.855896						314.819768	
							3429.794280					1324414938	724.619292	2829998634
							2105.379342							2105.379342
							x ^{1/2} = 1052.689671							

面積計算書

工区

2

ブロック

19-2

計算者



検算者



備考

福富 462-1(10)
福富 416-13

点	①	②	③	④	⑤	⑥	③ × ⑤		② × ⑥	
	X	X-(定数)	X _{n-1} -X _{n+1}	Y	Y-(定数)	Y _{n-1} -Y _{n+1}	+	-	+ -	
14	⁻¹⁵² 607.829	^{-152.600} 7.829	+35.591	⁻³⁶ 357.856	^{-36.350} 7.856	-17.498			101.647896	136.991842
5	637.825	37.825	+24.399	359.728	9.728	+31.241			237.353472	1181.690825
6	632.228	32.228	-35.591	384.097	34.097	+17.498	1213.546327			663.925446
15	602.234	2.234	-24.399	377.226	27.226	-31.241	664.287174			69.792396
							1877.833501	339.001368	206.784236	1745.616369
							1538.832133			1538.832133
							x 1/2 = 769.4160665			
15	⁻¹⁵² 602.234	^{-152.590} 17.234	+13.633	⁻³⁶ 377.226	^{-36.370} 7.226	-8.616			98.542058	105.408166
19	613.307	23.307	+8.513	379.763	9.763	+13.689			93.112419	319.069523
18	610.747	20.747	-13.633	390.915	20.915	+8.616	285.134195			178.756152
16	599.674	9.674	-8.513	388.379	18.379	-13.689	156.460427			132.427386
							441.594622	181.624477	237.825530	497.805675
							259.970165			259.970165
							x 1/2 = 129.9850725			

面積計算書

工
区

2

ブ
ロ
ック

19-2

計
算
者



精
算
者



備
考

福富 416-100
保 2-19-1

点	①	②	③	④	⑤	⑥	③ × ⑤		② × ⑥	
	X	X-(定数)	X _{n-1} -X _{n+1}	Y	Y-(定数)	Y _{n-1} -Y _{n+1}	+	-	+	-
19	613.307	13.307	+21.481	379.763	9.763	-6.818		209.719003	90.727126	
6	632.228	32.228	+16.360	384.097	14.097	+15.485		230.626920	499.050580	
7	629.667	29.667	-21.481	395.248	25.248	+6.818	542.352288		202.49606	
18	610.747	10.747	-16.360	390.915	20.915	-15.485	342.169400		166.47295	
							884.521688	440.365923	257.124221	701.320186
							444.175765			444.175765
							× 1/2 = 222.0878825			
16	599.674	9.674	+30.307	389.379	8.379	+5.504		253.962253	53.265696	
7	629.667	29.667	+29.687	395.248	15.248	+8.201		447.667376	325.307067	
8	629.361	29.361	-30.307	396.580	16.580	-5.504	502.490060		216.642946	
17	599.360	9.360	-29.687	389.744	9.744	-8.201	289.270128		76.761360	
							791.760188	706.609729	293.406306	378.554763
							85.150659			85.150659
							× 1/2 = 42.5752295			

面積計算書

工区

2

ブロック

19-2

計測者

計算者

備考

係 2-19-2-1 A

" B

点	①	②	③	④	⑤	⑥	③ × ⑤		② × ⑥		
	X	X-(定数)	X _{n-1} -X _{n+1}	Y	Y-(定数)	Y _{n-1} -Y _{n+1}	+	-	+	-	
17	⁻¹⁵² 599.860	⁻¹⁵² 500.000	-29.844	⁻³⁶ 389.744	⁻³⁶ 300.000	-7.51P	2678.31P36		747.087840		
A	599.517		+30.154	389.061		+6.171		2685.5453P4		614.11P407	
B	629.514		+29.844	395.915		+7.51P		2862.487260		923.815766	
8	629.361		-30.154	396.580		-6.171	2912.273320		798.286731		
								5590.593256	5428.032654	1545.374571	1587.935173
								42560602		42 560602	
										$\sum = 21280301$	
A	⁻¹⁵² 599.517	⁻¹⁵² 500.000	-29.840	⁻³⁶ 389.061	⁻³⁶ 300.000	-7.536	2657.580240		749.960112		
16	599.674		+30.150	388.87P		+6.187		2664.626850		616.683038	
7	629.667		+29.840	395.248		+7.536		2842.200320		977.170512	
B	629.514		-30.150	395.915		-6.187	2891.837250		801.303118		
								5549.417490	5506.827170	1551.263230	1593.863550
								42590320		42 590320	
										$\sum = 21295160$	

面積計算書		工区	2	ブロック	19-12	計算者	精算者	備考	福原山3-4 水路		
点	①	②	③	④	⑤	⑥	③	⑤	②	⑥	
	X	X-(定数)	X _{n-1} -X _{n+1}	Y	Y-(定数)	Y _{n-1} -Y _{n+1}	+	-	+	-	
17	⁻¹⁵² 599.360	^{-152.590} 9.360	+31.959	⁻³⁶ 389.744	^{-36.380} 9.744	-1.694			211.608496	1585.5860	
8	629.361	39.361	+19.510	396.580	16.580	+13.420			823.475800	528.226620	
9	618.870	28.870	-31.959	403.164	23.164	+1.694	740.298276			48905780	
10	597.402	7.402	-19.510	398.274	18.274	-13.420	256.525760		99.336860		
							1096.824016	634.884296	115.190680	577.130600	
							461.939720			461.939720	
							x 1/2 = 230.969860				
12	⁻¹⁵² 619.226	^{-152.590} 29.226	+25.723	⁻³⁶ 294.280	^{-36.290} 4.280	-103.104			110.094440	3013.317504	
1	621.623	31.623	-21.824	292.777	2.777	+103.994	60.605248			3288.602262	
10	597.402	7.402	-25.723	398.274	108.274	+103.104	2785.132102			763.175808	
11	595.900	5.900	+21.824	395.881	105.881	-103.994			2310.746944	613.564600	
							2845.737250	2420.841384	3626.882104	4051.778070	
							424.895966			424.895966	
							x 1/2 = 212.447983				

面積計算書		工区	2	ブロック	19-2	計算者	精算者	備考	階切 I, II		
点	①	②	③	④	⑤	⑥	③	⑤	②	⑥	
	X	X-(定数)	X _{n-1} -X _{n+1}	Y	Y-(定数)	Y _{n-1} -Y _{n+1}	+	-	+	-	
I	⁻¹⁵² 619.673	^{-152.610} 9.673	+2.397	⁻³⁶ 292.331	^{-36.290} 2.331	-1.503		5.587407	14.538519		
I	621.623	11.623	-0.447	292.777	2.777	+1.949	1.24319			22.653227	
II	619.226	9.226	-1.950	294.280	4.280	-0.446	8.346000		4.114796		
							9.587319	-5.587407	18.653315	22.653227	
							2.9999912			2.9999912	
							x ^{1/2} = 1.9999956				
Z	⁻¹⁵² 643.096	^{-152.640} 3.096	+1.959	⁻³⁶ 297.690	^{-36.290} 7.690	-8.528		15.064710	26.402688		
II	651.625	11.625	+6.590	299.642	9.642	+10.480		63.327940		121.830000	
3	649.666	9.666	-8.529	308.170	18.170	-1.952	154.971930		18.818032		
							154.971930	78.42650	45.270720	121.830000	
							76.559280			76.559280	
							x ^{1/2} = 38.279640				

面積計算書		工区	2	ブロック	19-2	計算者	精算者	備考	隅切ⅢⅣ			
点	①	②	③	④	⑤	⑥	③	×	⑤	②	×	⑥
	X	X-(定数)	X _{n-1} -X _{n+1}	Y	Y-(定数)	Y _{n-1} -Y _{n+1}	+		-	+		-
8	-152 629.361	-152.610 19.361	+8.532	-36 396.580	-36.390 6.580	+1.944			56.140560			27.637784
Ⅲ	627.402	17.402	-10.491	405.108	15.108	+6.584	158.498028					114.574768
9	618.870	8.870	+1.959	403.164	13.164	-8.528			25.788276	25.643360		
							158.498028	81.928836		75.643360	152.212552	
							76.569192					76.569192
												$\times \frac{1}{2} = 38.284596$
10	-152 597.402	-152.590 7.402	-0.468	-36 398.274	-36.390 8.274	+1.949			2.706752			14.426498
Ⅳ	595.452	5.452	-1.502	397.830	7.830	-2.393	11.760660			13.046636		
11	595.900	5.900	+1.950	395.881	5.881	+0.444			114.67950			2.619600
							15.46762	11.467950		13.046636		17.066098
							2.999462					2.999462
												$\times \frac{1}{2} = 1.999731$

計年月日

計算者



檢査者



B. NO. 19-2

各筆面積計算書

地番	算式	隅切	地積	摘要
	福富 441 441a25		806 21	
	福富 441a2(10)		1052 68	
	福富 442a1(10)		769 41	
	福富 416a13		129 98	
	福富 416a12		222 08	
	福富 418a4		280 98	
	保2-1 ² 1 ² -1		42 57	A. 21.28 B. 21.29
	水路		212 44	
	計		3466 36	
	全体		3466 39	
	差		0 05	
	換地		4211 44	
	保留地		42 57	
	水路		212 44	89