

BLOCK NO. 11-1

画地略図

工区

ホニ

ブロック

11-1

記入者



点検者

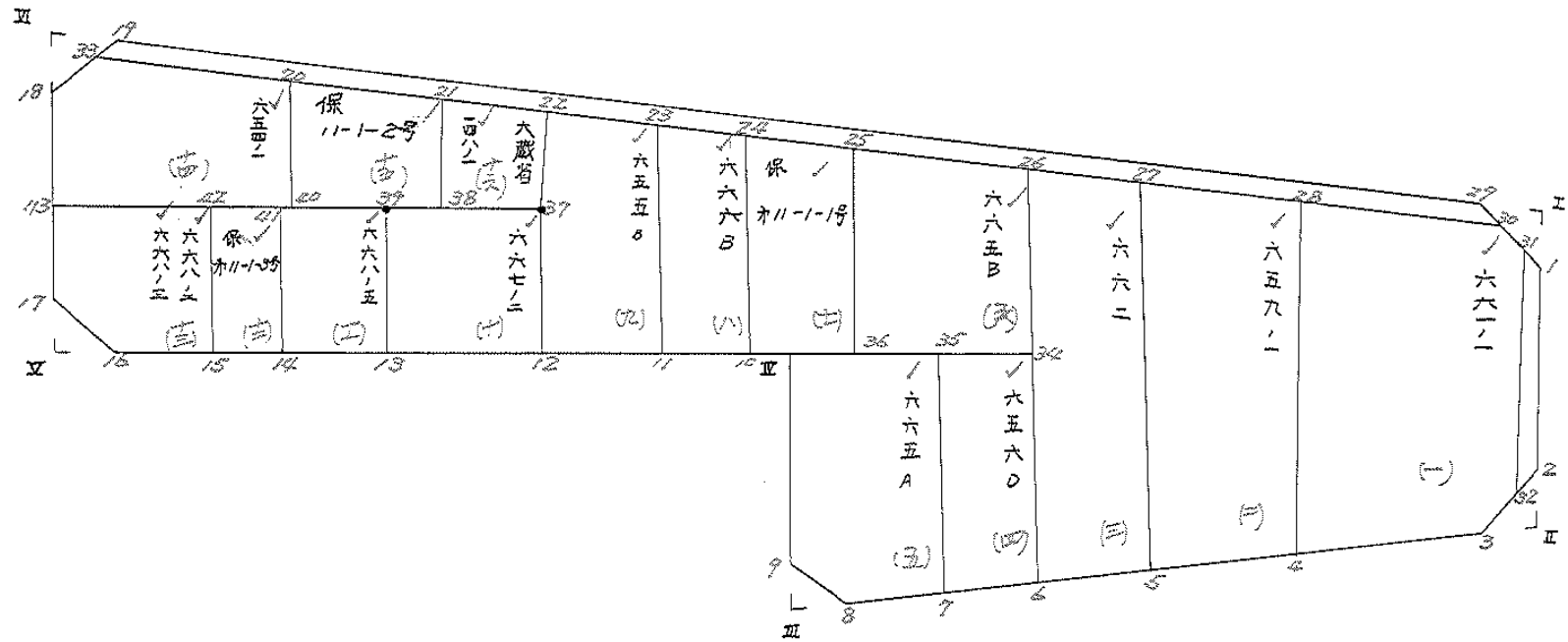
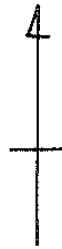

面積計算書

工
区

第2

ブ
ロ
ック

11-1

計
算
者



精
算
者



備
考

全
体

順	①	②	③	④	⑤	⑥	③ × ⑤		② × ⑥	
	X	X-(定数)	X _{n-1} -X _{n+1}	Y	Y-(定数)	Y _{n-1} -Y _{n+1}	+	-	+	-
	-152,	-152,200		-32,	-32,400					
1	266,220	66,220+	18,121	441,777	41,777-	1,273		757,403,437	25,706,040	
2	280,744	80,744+	16,635	443,149	43,149+	3,520		717,783,615	285,026,320	
3	282,915	82,915+	10,645	446,327	46,327+	95,773		482,325,915	794,018,295	
8	291,387	91,387+	6,655	538,922	38,922+	95,517		924,525,910	8729,203,113	
9	287,570	87,570-	30,725	540,844	40,844+	0,902	4327,431,900		80,792,140	
11	260,664	60,664-	50,085	539,824	39,824+	71,031	4486,253,040		2522,304,684	
16	257,125	57,125-	5,247	631,875	31,875+	93,972	1216,148,125		5402,095,390	
17	255,417	55,417-	30,908	633,778	33,778+	0,682	8161,420,394		37,774,394	
18	222,577	22,577-	35,168	632,657	32,657-	4,278	8178,544,376		76,584,466	
19	220,249	20,249+	10,046	629,520	29,520-	188,115		9771,257,926	3209,140,635	
29	262,623	62,623+	16,021	444,442	44,442-	187,723		2045,709,702	11,755,777,429	
							26370,318,225	14,119,286,479	15,747,202,516	27998,234,236
							12251,031,726			12251,031,726
									1/2 = 6125,515,863	

画地計算

面積計算書

工区

第2

ブロック

11-1

計算者



計算者

備考

(-) 661-1
(=) 659-1

点	①	②	③	④	⑤	⑥	③ × ⑤		② × ⑥	
	X	X-(定数)	X _{n-1} -X _{n+1}	Y	Y-(定数)	Y _{n-1} -Y _{n+1}	+	-	+	-
	-152	-152,250		-38	-38,400					
30	263.254	13.254+	9.480	443.552	43.552-	37.048			42.872760	313.262772
31	265.049	13.049+	17.974	442.687	42.687+	0.705			78.145866	10.609345
32	281.848	31.848+	17.846	444.257	44.257+	2.638			770.575362	84.015024
3	282.915	32.915+	4.277	445.327	45.327+	36.545			173.954223	1202.878.675
4	286.127	36.127-	27.346	480.802	80.802+	34.410	2209.611472			1243.130.070
28	235.557	3.557-	22.273	477.737	77.737-	37.250	1775782201		267.445230	
							3985.392673	2165.482621	720.708262	510.533314
							1819.925072			1819.925072
									1/2 = 909.962536	
	-152	-152,250		-38	-38,400					
4	286.127	36.127+	37.659	480.802	80.802+	24.272			2638.912318	876.874544
5	288.228	38.228-	36.812	504.087	104.087+	21.883	3724.770308			836.543224
27	250.315	2.315-	32.657	502.685	102.685-	24.272	3353.389415			7.645.686
28	235.557	3.557+	33.812	477.737	77.737-	21.883			2835.541444	121.866427
							7078.359723	3494.453962	129.312107	1713.47858
							133.925761			133.925761
									1/2 791.9428805	

面積計算書

工区

北

ブロック

11-1

計算者



精算者

備考

ニ) 662
ロ) 6560

点	①	②	③	④	⑤	⑥	③ × ⑤		② × ⑥	
	X	X-(定数)	X _{n-1} -X _{n+1}	Y	Y-(定数)	Y _{n-1} -Y _{n+1}	+	-	+	-
5	-152 288.272	-152.200 28.272+	37.065	304.207	4.007+	14.047			156.611585	1739.338716
6	287.380	57.380-	40.775	316.732	16.732+	11.261	682.581940			1006.508180
26	267.433	47.433-	37.065	315.270	15.270-	14.047	596.522550			666.291351
27	250.315	50.315+	40.775	302.685	2.685-	11.261			109.334575	366.097215
							1279.104490	26.146160	122.888566	22618.46396
							1012.958330			1012.958330
									1/2 = 505.479165	
6	-152 287.380	-152.200 28.380+	28.618	316.732	16.732+	7.066			478.836376	310.319680
7	290.112	70.112-	28.164	324.826	24.826+	7.084	679.199464			638.253408
35	261.216	61.216-	28.618	323.916	23.916-	7.066	681.866288			334.784256
34	261.574	61.574+	28.164	313.760	15.760-	7.084			113.864640	135.823496
							1380.765752	722.701016	990.607752	1418.672488
							1158.064726			1158.064726
									1/2 = 229.032368	

面積計算書

工区

72

ブロック

11-1

計算者



精算者



備考

(E) 665A
(A) 665B

点	①	②	③	④	⑤	⑥	③ × ⑤		② × ⑥	
	X	X-(定数)	X _{n-1} -X _{n+1}	Y	Y-(定数)	Y _{n-1} -Y _{n+1}	+	-	+	-
7	-152, 270.112	-152,200 90.112	+ 30.173	-38, 524.826	-38,500 24.826	+ 15.106				1261.231872
8	271.387	91.387	- 0.342	538.922	38.922	+ 16.018	21.085724			1463.869002
9	287.570	27.570	- 30.725	540.845	40.845	+ 0.902	1254.931200			80.792140
10	260.664	60.664	- 28.364	537.800	37.800	- 17.028	1129.169696			1032.986592
35	261.216	61.216	+ 27.448	523.216	23.216	- 14.998				
							2405.197320	1430.408466	1951.106160	2705.893016
							954.788854			300.4773046
										934.788854
										1/2 = 477.394427
34	-152, 261.474	-152,200 61.474	+ 13.407	-38, 515.760	-38,500 15.760	+ 17.376				1192.737624
36	260.847	60.847	- 12.360	534.660	34.660	+ 13.287	636.467760			1112.739338
25	243.134	43.134	- 13.407	534.047	34.047	- 17.376	456.563041			836.627064
26	247.433	47.433	+ 12.360	518.270	18.270	- 18.287				
							173.030801	191.683040	1704.127200	2305.476762
							601.347761			601.347761
										1/2 = 300.6738805

面積計算書

工区

第2

ブロック

11-1

計算者

精算者

備考

(イ) 保第11-1号
(ロ) 666B

点	①	②	③	④	⑤	⑥	③	×	⑤	②	×	⑥
	X	X-(定数)	Xn-1-Xn+1	Y	Y-(定数)	Yn-1-Yn+1	+		-	+		-
	-152	-152,200		-38	-38,500							
36	260.810	60.810+	17.530	324.665	324.665+	5.775			607.694980			351.362550
70	260.664	60.664-	9.332	339.824	339.824+	7.616	13,221,568					583,745,024
10	260.510	60.510-	17.715	344.782	344.782+	3.771	873,063,912					228,183,210
24	240.748	40.748-	17.376	313.595	313.595-	10.233	727,506,720			419,070,884		
25	243.134	43.134+	17.894	324.027	324.027-	8.927			577,370,806	385,143,426		
							1643,792,200	1285,065,786	804,164,370	1,142,890,784		
							358,726,414					358,726,414
									1/2 = 179,363,207			
	-152	-152,200		-38	-38,500							
10	260.510	60.510+	17.357	344.782	344.782+	6.632			857,166,674			401,302,320
11	260.305	60.305-	20.914	350.227	350.227+	5.217	10,504,474,78					314,731,795
23	237.576	37.576-	17.357	327.501	327.501-	6.632	958,190,857			262,600,672		
24	240.748	40.748+	20.914	323.575	323.575-	3.217			911,745,830	213,707,612		
							20,086,383,35	176,870,504	476,308,284	716,034,115		
							239,725,831					239,725,831
									1/2 = 179,862,915			

面積計算書

工区

※2

ブロック

11-1

計算者



精算者



備考

(2) 655 B

(4) 667-2

点	①	②	③	④	⑤	⑥	+	-	②	+	⑥	
	X	X-(定数)	X _{n-1} -X _{n+1}	Y	Y-(定数)	Y _{n-1} -Y _{n+1}						
	-152,	-152,200		-38,	-38,500							
11	260.305,	60.305	20.286	550.227,	50.227	12.966			1018.904922		781.914630	
12	259.282,	59.282	13.972	562.467,	62.467	11.353	874.038264				679.840345	
37	246.313,	46.313	22.907	561.580,	61.580	1.679	1410.613060				70.349447	
22	236.975,	36.975	6.717	560.948,	60.948	12.077	409.387716				446.621025	
23	239.596,	39.596	23.330	567.501,	67.501	10.721		1154.858330	424.508716			
									2592.037040	2173.763252	941.477198	1461.754776
									520.275788			520.275788
												1/2 = 260.137894
12	-152,	-152,200		-38,	-38,500							
12	259.282,	59.282	12.875	562.467,	62.467	20.987			804.262625		1256.743524	
13	259.188,	59.188	13.006	562.567,	62.567	18.052	1239.000402				1068.461776	
37	246.376,	46.376	12.875	560.579,	60.579	20.987	1036.682125				941.812612	
37	246.313,	46.313	15.006	561.580,	61.580	18.052		924.069480	836.042276			
									2275.652527	1728.332105	1777.854388	2325.203310
									347.350422			347.350422
												1/2 = 273.675211

面積計算書

工区

第2

ブロック

11-1

計算者

精算者

備考

(1) 668-5

(2) 保第11-1-3号

点	①	②	③	④	⑤	⑥	③	×	⑤	②	×	⑥
	X	X-(定数)	X _{n-1} -X _{n+1}	Y	Y-(定数)	Y _{n-1} -Y _{n+1}	+	-	+	-		
	-152,	-152,200		-38,	-38,500							
13	257.188,	57.188+	12.742	382.567,	82.567+	12.753			1151.149114			754.824564
14	258.218,	58.218-	14.977	573.272,	93.272+	9.827	1389.800184					578.122122
41	244.171,	44.171-	13.742	572.376,	92.376-	12.753	1288.185032					563.567823
37	244.876,	44.876+	14.977	580.517,	80.517-	9.827			1207.543443	441.086204		
									2656.795216	2358.572557	1004.654027	1332.746686
									328.272657			328.272657
									1/2 = 164.1463275			
	-152,	-152,200		-38,	-38,500							
14	258.818,	58.818+	14.386	573.272,	93.272+	7.851			1341.810992			461.780112
15	258.577,	58.577-	15.046	600.247,	100.247+	6.406	1008.316362					375.244262
42	243.772,	43.772-	14.386	577.678,	97.678-	7.851	1433.967108					343.653972
41	244.171,	44.171+	15.046	572.376,	92.376-	6.406			1390.190216	283.087546		
									2742.284076	2752.001208	626.751518	837.024380
									210.282862			210.282862
									1/2 = 105.141431			

面積計算書

工区

第2

ブロック

11-1

計算者

精算者

備考

(区) 668-2.-3.

(地) 634-1

点	①	②	③	④	⑤	⑥	③	×	⑤	②	×	⑥
	X	X-(定数)	X _{n-1} -X _{n+1}	Y	Y-(定数)	Y _{n-1} -Y _{n+1}	+		-	+		-
	-152	-152,200		-38	-38,500							
15	252.577	59.577	+ 13.713	600.247	102.247	+ 52.197			1374.687111			1286.003669
16	257.485	57.485	- 3.160	631.875	131.875	+ 33.551	416.725000					1928.679235
17	255.417	55.417	- 15.651	633.778	132.778	+ 1.410	2094.072498					78.137.970
43	241.834	41.834	- 11.645	633.285	133.285	- 34.120	152.103825			1142.376080		
42	243.772	43.772	+ 16.743	599.678	99.678	- 33.038			1668.208754	1446.139326		
							1062.701323	30.43	575865	2973.515416	3572.820874	
							1017.325.258					1017.305.458
										1/2 = 307.452729		
18	222.577	22.577	- 20.775	632.357	132.357	- 2.735	2756.522815			61.74.8095		
33	221.039	21.039	+ 7.495	630.550	130.550	- 11.159			978.472250	872.255.901		
26	230.072	30.072	+ 23.181	591.078	91.078	- 38.634			2111.742738	1162.403088		
40	244.220	44.220	+ 11.762	591.276	91.276	+ 42.187			1080.880757			1865.509140
43	241.834	41.834	- 21.643	633.285	133.285	+ 40.661	2884.687255					1701.012274
							5641.210070	4171.095740	2096.407084	3566.521414		
							1470.144330					1470.144330
										1/2 = 735.057165		

面積計算書

工区

第2

ブロック

11-1

計算者



精算者



備考

(注)

保 11-1-25

大蔵省 148-1

点	①	②	③	④	⑤	⑥	③ × ⑤	② × ⑥
	X	X-(定数)	X _{n-1} -X _{n+1}	Y	Y-(定数)	Y _{n-1} -Y _{n+1}	+	-
20	-152, 230.072	-152, 200 30.072	- 7.103	-38, 371.078	-38, 500 71.072	- 22.834	829.265094	686.664018
21	235.117	35.117	+ 15.620	557.062	67.062	- 21.396	1078.748440	749.256312
38	245.672	45.672	+ 7.757	557.762	67.762	+ 11.457	680.807358	523.493244
37	244.876	44.876	- 1.472	580.57	20.57	+ 22.134	118.523968	993.285384
40	244.220	44.220	- 14.804	571.876	71.876	+ 10.577	1360.428384	467.803380
							2308.274461	1757.545778
							1435.970360	1784.382008
							548.651648	548.651648
							1/2 = 274.330824	
21	-152, 235.117	-152, 200 35.117	- 8.717	-38, 557.062	-38, 500 7.062	- 8.314	72.993454	309.521238
22	236.975	36.975	+ 11.196	560.748	0.748	- 7.482	10.613808	276.646950
37	246.313	46.313	+ 8.717	561.580	1.580	+ 8.314	13.772860	408.202782
38	245.672	45.672	- 11.176	557.762	7.762	+ 7.482	109.295322	341.867544
							188.288206	24.386548
							386.168188	720.070326
							163.902138	163.902138
							1/2 = 81.951069	

面積計算書

工区

和

ブロック

11-1

計算者



測定者



備考

水路第2号線
水路第4号線

点	①	②	③	④	⑤	⑥	③ × ⑤	② × ⑥
	X	X-(定数)	X _{n-1} -X _{n+1}	Y	Y-(定数)	Y _{n-1} -Y _{n+1}	+ -	+ -
	-152	-152,200		-38	-38,400			
19	220.217	20.217 +	11.584	627.320	227.520 -	186.108	244359680	3768500892
27	262.623	62.623 +	13.605	444.442	44.442 -	183968	197893410	11645874064
30	263.854	63.854 -	11.584	443.552	43.552 +	186.108	111066368	11883740232
33	221.037	21.037 -	13.605	630.350	230.350 +	185.768	10023132750	392580702
							11864199118	11482253090
							154437476	15776320984
							381.946028	381.946028
								1/2 = 170.973014
	-152	-152,200		-38	-38,400			
1	266.280	66.280 +	15.575	441.777	1777 +	0.462	28203915	30621360
2	280.744	80.744 +	15.568	443.149	3.149 +	2.460	49023632	198630240
32	281.848	81.848 -	15.575	444.257	4.257 -	0.462	66813615	37813776
31	265.027	65.027 -	15.568	442.687	2.687 -	2.460	41.831216	160.020540
							103.604831	77.227547
							177934316	227.251600
							31.417284	31.417284
								1/2 = 15.708642

計年 月 算日	計算者	検査者
---------------	-----	-----

水
B.NO. 11-1

2枚の内1.
各筆面積計算書

地番	算式	隅切	地積	摘要
1	661-1		909.96	
2	659-1		791.75	
3	662		506.47	
4	6560		227.03	
5	665A		471.37	
6	665B		300.67	
7	保留地 水11-1-1号		179.36	
8	666B		117.86	
9	655B		260.13	
10	667-B		273.67	
11	668-5		164.14	
12	保留地 水11-1-3号		105.14	
13	668-2, 668-3		509.65	
14	654-1		735.05	
15	保留地 第11-1-2号		274.33	
16	大蔵省 142-1		81.95	
	水路第8号線		190.97	
	水路第6号線		15.70	
		計	6125.42	
		全体	6125.51	
		差	+ 0.09	

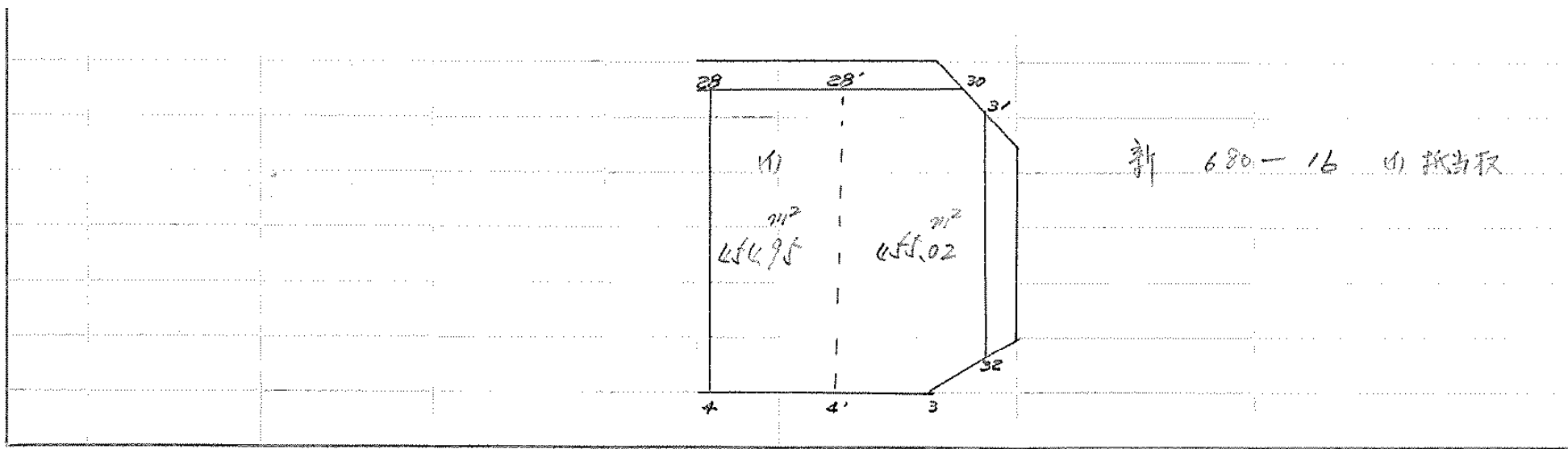

面積計算書

工
区

ブ
ロ
ック

計
算
者

精
算
者

備
考

新保680-16

点	①	②	③	④	⑤	⑥	③ × ⑤		② × ⑥	
	X	X - (定数)	X _{n-1} - X _{n+1}	Y	Y - (定数)	Y _{n-1} - Y _{n+1}	+	-	+	-
4	-152 286.127	-152.250 26.127	+29.081	-38 480.802	-38.450 20.802	-15.251			604.942962	50.972877
4'	284.650	34.650	-26.863	464.486	4.486	-17.201	120.507418		596.014650	
20'	259.264	9.264	-29.081	463.601	3.601	+15.251	104.720681			141.285264
28	255.569	5.569	+26.863	479.737	19.737	+17.201		530.175031		25.792369
							225.228099	1125.137993	1146.887527	227.077633
									909.909294	909.909294
									1/2 = 454.954947	
28'	-152 259.264	-152.250 9.264	-20.796	-38 463.601	-38.440 23.601	-20.934	480.806396		193.932576	
30	263.854	13.854	+5.785	443.552	3.552	-20.914		20.548320	289.742556	
31	265.049	15.049	+17.994	442.687	2.687	+0.705		48.349878		10.609545
32	281.848	31.848	+17.866	444.257	4.257	+2.640		76.055562		84.078720
3	282.915	32.915	+2.802	445.327	5.327	+20.229		14.926254		665.837135
4'	284.650	34.650	-23.651	464.486	24.486	+18.274	579.118386			633.194100
							166.9924782	159.880014	483.675132	1393.719900
							910.044768			910.044768
									1/2 = 455.022384	