

6街区

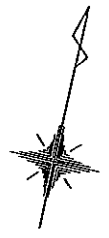

S = 1 / 500

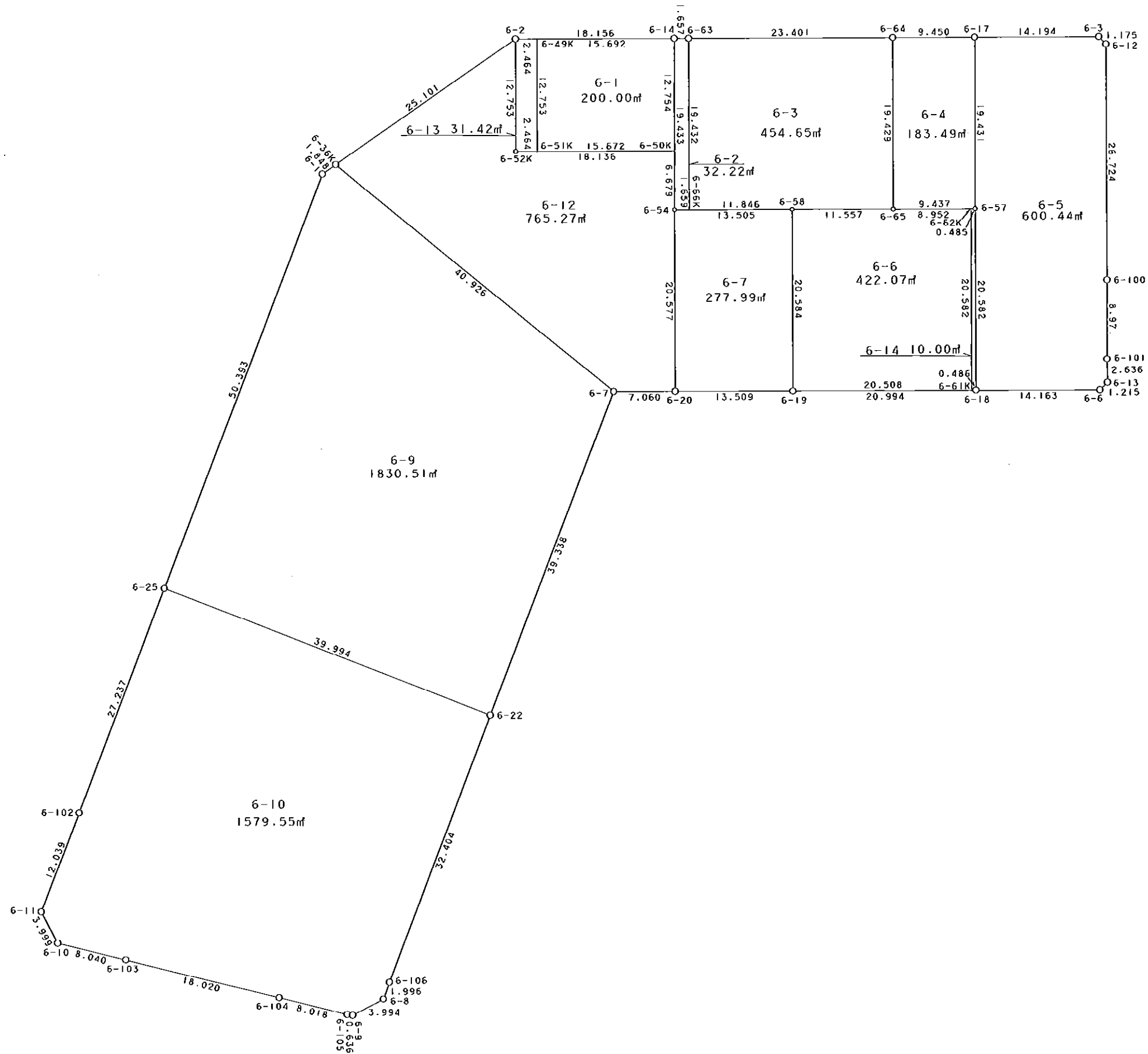

凡 例

記号	名称
⊙	地区界点
○	街区点
○	画地点 (折れ点)
— —	画地点 (直線中)

地番	筆種別	面積	坪数
6-1	筆界	200.00	60.50
6-2	筆界	32.22	9.74
6-3	筆界	454.65	137.53
6-4	筆界	183.49	55.50
6-5	筆界	600.44	181.63
6-6	筆界	422.07	127.67
6-7	筆界	277.99	84.09
6-9	筆界	1830.51	553.73
6-10	筆界	1579.55	477.81
6-12	筆界	765.27	231.49
6-13	筆界	31.42	9.50
6-14	筆界	10.00	3.02
	合計	6387.61	1932.21

面積 (座標法) 計算書

地番 = 6-1
測点名

	[1] X (i)	[2] X (i+1)-X (i-1)	[3] Y (i)	[4] Y (i+1)-Y (i-1)	[2]*[3]	[1]*[4]	方向角	夾角	距離
6-51K	-149632.893	-8.893	-41616.396	18.144	370094.609628	-2714939.210592	76-58-32	90-00-14	15.672
6-50K	-149629.361	15.962	-41601.127	12.413	-664037.189174	-1857349.258093	347-03-36	90-05-04	12.754
6-14	-149616.931	8.893	-41603.983	-18.144	-369984.220819	2714649.596064	256-58-24	89-54-48	15.692
6-49K	-149620.468	-15.962	-41619.271	-12.413	664326.803702	1857238.869284	166-58-18	89-59-54	12.753
合計				倍面積 面積	400.003337 200.00	-400.003337 200.00			56.871

面積 (座標法) 計算書

地番 = 6-2
測点名

	[1] X (i)	[2] X (i+1)-X (i-1)	[3] Y (i)	[4] Y (i+1)-Y (i-1)	[2]*[3]	[1]*[4]	方向角	夾角	距離
6-63	-149616.559	18.566	-41602.368	-5.969	-772389.564288	893061.240671	257-01-43	89-58-35	1.657
6-14	-149616.931	-19.311	-41603.983	2.737	803414.515713	-409501.540147	167-03-31	90-01-48	19.433
6-54	-149635.870	-18.566	-41599.631	5.969	772338.749146	-893176.508030	77-00-38	89-57-07	1.659
6-66K	-149635.497	19.311	-41598.014	-2.737	-803299.248354	409552.355289	347-03-08	90-02-30	19.432
合計				倍面積 面積	64.452217 32.22	-64.452217 32.22			42.181

面積 (座標法) 計算書

地番 = 6-3
測点名

	[1] X (i)	[2] X (i+1)-X (i-1)	[3] Y (i)	[4] Y (i+1)-Y (i-1)	[2]*[3]	[1]*[4]	方向角	夾角	距離
6-63	-149616.559	-24.183	-41602.368	-18.452	1006070.065344	2760724.746668	167-03-08	90-00-15	19.432
6-66K	-149635.497	-16.276	-41598.014	15.897	677049.275864	-2378755.495809	77-00-49	89-57-41	11.846
6-58	-149632.835	5.248	-41586.471	22.807	-218245.799808	-3412676.067845	77-04-12	180-03-23	11.557
6-65	-149630.249	21.521	-41575.207	6.909	-894740.029847	-1033795.390341	347-02-51	89-58-39	19.429
6-64	-149611.314	13.690	-41579.562	-27.161	-569224.203780	4063592.899554	257-02-53	90-00-02	23.401
合計				倍面積 面積	909.307773 454.65	-909.307773 454.65			85.665

面積 (座標法) 計算書

地番 = 6-4
測点名

	[1] X (i)	[2] X (i+1)-X (i-1)	[3] Y (i)	[4] Y (i+1)-Y (i-1)	[2]*[3]	[1]*[4]	方向角	夾角	距離
6-65	-149630.249	-16.814	-41575.207	13.551	699045.530498	-2027639.504199	77-00-44	89-57-53	9.437
6-57	-149628.128	21.060	-41566.011	4.853	-875380.191660	-726145.305184	347-05-04	90-04-20	19.431
6-17	-149609.189	16.814	-41570.354	-13.551	-698963.932156	2027354.120139	257-00-18	89-55-14	9.450
6-64	-149611.314	-21.060	-41579.562	-4.853	875665.575720	726063.706842	167-02-51	90-02-33	19.429
合計				倍面積 面積	366.982402 183.49	-366.982402 183.49			57.747

面積 (座標法) 計算書

地番 = 6-5
測点名

	[1] X (i)	[2] X (i+1)-X (i-1)	[3] Y (i)	[4] Y (i+1)-Y (i-1)	[2] * [3]	[1] * [4]	方向角	夾角	距離
6-18	-149648.186	-16.889	-41561.395	18.420	701930.400155	-2756519.586120	77-04-14	90-01-50	14.163
6-6	-149645.017	4.194	-41547.591	14.456	-174250.596654	-2163268.365752	32-27-37	135-23-23	1.215
6-13	-149643.992	3.588	-41546.939	0.035	-149070.417132	-5237.539720	346-27-52	134-00-15	2.636
6-101	-149641.429	11.311	-41547.556	-2.603	-469944.405916	389516.639687	347-12-34	180-44-42	8.971
6-100	-149632.681	34.792	-41549.542	-7.974	-1445591.665264	1193170.998294	347-03-06	179-50-32	26.724
6-12	-149606.637	26.675	-41555.530	-6.979	-1108493.762750	1044104.719623	302-29-10	135-26-04	1.175
6-3	-149606.006	-2.552	-41556.521	-14.824	106052.241592	2217759.432944	257-02-30	134-33-20	14.194
6-17	-149609.189	-22.122	-41570.354	-9.490	919619.371188	1419791.203610	167-05-04	90-02-34	19.431
6-57	-149628.128	-38.997	-41566.011	8.959	1620949.730967	-1340518.398752	167-02-24	179-57-20	20.582
合計				倍面積 面積	1200.896186 600.44	-1200.896186 600.44			109.091

面積 (座標法) 計算書

地番 = 6-6
測点名

	[1] X (i)	[2] X (i+1)-X (i-1)	[3] Y (i)	[4] Y (i+1)-Y (i-1)	[2] * [3]	[1] * [4]	方向角	夾角	距離
6-62K	-149628.237	18.046	-41566.484	-13.338	-750108.770264	1995741.425106	257-00-42	89-58-08	8.952
6-65	-149630.249	-4.598	-41575.207	-19.987	191162.801786	2990659.786763	257-04-12	180-03-30	11.557
6-58	-149632.835	-22.646	-41586.471	-6.647	941767.222266	994609.454245	167-02-19	89-58-07	20.584
6-19	-149652.895	-15.460	-41581.854	24.602	642855.462840	-3681760.522790	77-02-16	89-59-57	20.508
6-61K	-149648.295	24.658	-41561.869	15.370	-1024832.565802	-2300094.294150	347-02-34	90-00-18	20.582
合計				倍面積 面積	844.150826 422.07	-844.150826 422.07			82.183

面積 (座標法) 計算書

地番 = 6-7
測点名

	[1] X (i)	[2] X (i+1)-X (i-1)	[3] Y (i)	[4] Y (i+1)-Y (i-1)	[2] * [3]	[1] * [4]	方向角	夾角	距離
6-20	-149655.924	-17.025	-41595.019	17.777	708155.198475	-2660433.360948	77-02-34	89-59-40	13.509
6-19	-149652.895	23.089	-41581.854	8.548	-960083.427006	-1279232.946460	347-02-19	89-59-45	20.584
6-58	-149632.835	17.025	-41586.471	-17.777	-708009.668775	2660022.907795	257-00-48	89-58-29	13.505
6-54	-149635.870	-23.089	-41599.631	-8.548	960493.880159	1279087.416760	167-02-54	90-02-06	20.577
合計				倍面積 面積	555.982853 277.99	-555.982853 277.99			68.175

面積 (座標法) 計算書

地番 = 6-9

測点名	[1] X (i)	[2] X (i+1)-X (i-1)	[3] Y (i)	[4] Y (i+1)-Y (i-1)	[2] * [3]	[1] * [4]	方向角	夾角	距離
6-25	-149690.742	-55.572	-41647.086	32.412	2314411.863192	-4851776.329704	98-10-56	89-59-48	39.994
6-22	-149696.434	33.246	-41607.499	45.184	-1383282.911754	-6763883.673856	8-10-47	89-59-51	39.338
6-7	-149657.496	56.932	-41601.902	-31.161	-2368479.484664	4663477.232856	296-04-59	107-54-12	40.926
6-36K	-149639.502	16.634	-41638.660	-38.009	-692617.470440	5687647.831518	222-36-34	106-31-35	1.848
6-1	-149640.862	-51.240	-41639.911	-8.426	2133629.039640	1260873.903212	188-11-08	145-34-34	50.393
合計				倍面積 面積	3661.035974 1830.51	-3661.035974 1830.51			172.499

面積 (座標法) 計算書

地番 = 6-10

測点名	[1] X (i)	[2] X (i+1)-X (i-1)	[3] Y (i)	[4] Y (i+1)-Y (i-1)	[2] * [3]	[1] * [4]	方向角	夾角	距離
6-11	-149729.611	-14.942	-41652.720	0.860	622374.942240	-128767.465460	139-17-24	130-56-28	3.999
6-10	-149732.642	-3.124	-41650.112	10.647	130114.949888	-1594203.439374	90-39-46	131-22-22	8.040
6-103	-149732.735	-0.330	-41642.073	26.057	13741.884090	-3901585.875895	90-45-13	180-05-27	18.020
6-104	-149732.972	-0.393	-41624.055	26.034	16358.253615	-3898148.193048	91-06-54	180-21-41	8.018
6-105	-149733.128	-0.121	-41616.039	8.651	5035.540719	-1295341.290328	86-50-43	175-43-49	0.636
6-9	-149733.093	2.642	-41615.404	3.661	-109947.897368	-548172.853473	49-15-14	142-24-31	3.994
6-8	-149730.486	4.585	-41612.378	3.294	-190792.753130	-493212.220884	7-42-58	138-27-44	1.996
6-106	-149728.508	34.052	-41612.110	4.879	-1416975.569720	-730525.390532	8-10-51	180-27-53	32.404
6-22	-149696.434	37.766	-41607.499	-34.976	-1571348.807234	5235782.475584	278-10-56	90-00-05	39.994
6-25	-149690.742	-21.266	-41647.086	-43.473	885666.930876	6507505.626966	188-12-10	90-01-14	27.237
6-102	-149717.700	-38.869	-41650.972	-5.634	1618931.630668	843509.521800	188-20-56	180-08-46	12.039
合計				倍面積 面積	3159.104644 1579.55	-3159.104644 1579.55			156.377

面積 (座標法) 計算書

地番 = 6-12

測点名	[1] X (i)	[2] X (i+1)-X (i-1)	[3] Y (i)	[4] Y (i+1)-Y (i-1)	[2] * [3]	[1] * [4]	方向角	夾角	距離
6-36K	-149639.502	-36.473	-41638.660	19.770	1518686.846180	-2958372.954540	116-04-59	73-29-25	40.926
6-7	-149657.496	-16.422	-41601.902	43.641	683186.434644	-6531202.782936	77-08-06	141-03-07	7.060
6-20	-149655.924	21.626	-41595.019	2.271	-899533.880894	-339868.603404	347-02-54	89-54-48	20.577
6-54	-149635.870	26.563	-41599.631	-6.108	-1105010.998253	913975.893960	347-03-22	180-00-28	6.679
6-50K	-149629.361	2.422	-41601.127	-19.166	-100757.929594	2867796.332926	256-58-36	89-55-14	18.136
6-52K	-149633.448	8.338	-41618.797	-20.545	-347017.529386	3074219.189160	346-58-18	269-59-42	12.753
6-2	-149621.023	-6.054	-41621.672	-19.863	251977.602288	2971922.379849	222-35-34	55-37-16	25.101
合計				倍面積 面積	1530.544985 765.27	-1530.544985 765.27			131.232

面積 (座標法) 計算書

地番 = 6-13
測点名

	[1] X (i)	[2] X (i+1)-X (i-1)	[3] Y (i)	[4] Y (i+1)-Y (i-1)	[2] * [3]	[1] * [4]	方向角	夾角	距離
6-49K	-149620.468	11.870	-41619.271	-5.276	-494020.746770	789397.589168	256-59-04	90-00-46	2.464
6-2	-149621.023	-12.980	-41621.672	0.474	540249.302560	-70920.364902	166-58-18	89-59-14	12.753
6-52K	-149633.448	-11.870	-41618.797	5.276	494015.120390	-789466.071648	76-59-04	90-00-46	2.464
6-51K	-149632.893	12.980	-41616.396	-0.474	-540180.820080	70925.991282	346-58-18	89-59-14	12.753
合計					62.856100 倍面積 面積 31.42	-62.856100 31.42			30.434

面積 (座標法) 計算書

地番 = 6-14
測点名

	[1] X (i)	[2] X (i+1)-X (i-1)	[3] Y (i)	[4] Y (i+1)-Y (i-1)	[2] * [3]	[1] * [4]	方向角	夾角	距離
6-61K	-149648.295	-19.949	-41561.869	5.089	829117.724681	-761560.173255	77-02-58	90-00-24	0.486
6-18	-149648.186	20.167	-41561.395	-4.142	-838168.652965	619842.786412	347-02-24	89-59-26	20.582
6-57	-149628.128	19.949	-41566.011	-5.089	-829200.353439	761457.543392	257-01-23	89-58-59	0.485
6-62K	-149628.237	-20.167	-41566.484	4.142	838271.282828	-619760.157654	167-02-34	90-01-11	20.582
合計					20.001105 倍面積 面積 10.00	-20.001105 10.00			42.135