

西部第4地区土地区画整理事業 出来形確認測量（原子図）

21街区

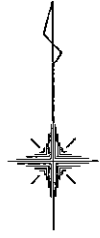

S = 1 / 500

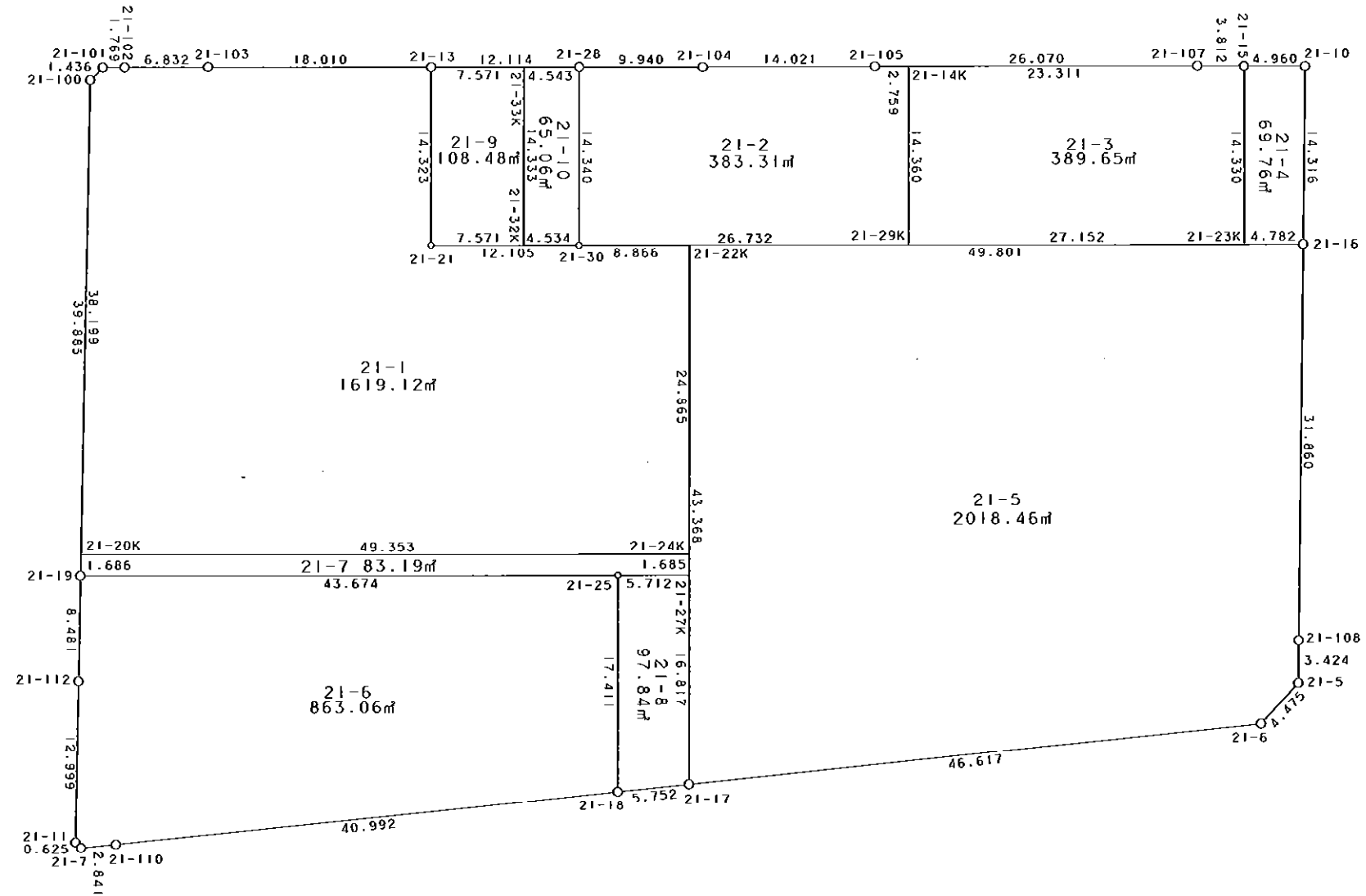

凡 例

記号	名称
⊙	地区界点
○	街区点
○	画地点(折れ点)
	画地点(直線中)

面積 (座標法) 計算書

地番 = 21街区

測点名	[1] X (i)	[2] X (i+1)-X (i-1)	[3] Y (i)	[4] Y (i+1)-Y (i-1)	[2] * [3]	[1] * [4]	方向角	夾角	距離
21-101	-149750.043	-0.995	-41270.757	-2.800	41064.403215	419300.120400	225-54-11	135-46-25	1.436
21-100	-149751.042	-40.871	-41271.788	-2.032	1686819.247348	304294.117344	181-26-17	135-32-06	39.885
21-19	-149790.914	-48.351	-41272.789	-1.191	1995580.620939	178400.978574	181-17-01	179-50-44	8.481
21-112	-149799.393	-21.474	-41272.979	-0.515	886295.951046	77146.687395	181-25-58	180-08-57	12.999
21-11	-149812.388	-13.423	-41273.304	0.130	554011.559592	-19475.610440	133-14-55	131-48-57	0.625
21-7	-149812.816	-0.170	-41272.849	3.284	7016.384330	-491985.287744	84-47-21	131-32-26	2.841
21-110	-149812.558	4.239	-41270.020	43.627	-174943.614780	-6535872.467866	84-25-37	179-38-16	40.992
21-18	-149808.577	4.542	-41229.222	46.523	-187263.126324	-6969544.427771	84-24-12	179-58-35	5.752
21-17	-149808.016	5.094	-41223.497	52.121	-209992.493718	-7808143.601936	84-25-11	180-00-59	46.617
21-6	-149803.483	7.810	-41177.101	49.444	-321593.158810	-7406883.413452	42-55-35	138-30-24	4.475
21-5	-149800.206	6.701	-41174.053	3.085	-275907.329153	-462133.635510	0-37-09	137-41-34	3.424
21-108	-149796.782	35.279	-41174.016	0.595	-1452578.110464	-89129.085290	1-00-13	180-23-04	31.860
21-16	-149764.927	46.169	-41173.458	0.787	-1900937.382402	-117864.997549	0-55-00	179-54-47	14.316
21-10	-149750.613	14.357	-41173.229	-4.731	-591124.048753	708470.150103	270-29-48	89-34-48	4.960
21-15	-149750.570	0.095	-41178.189	-8.772	-3911.927955	1313612.000040	270-46-54	180-17-06	3.812
21-107	-149750.518	0.196	-41182.001	-29.882	-8071.672196	4474844.978876	270-18-59	179-32-05	26.070
21-105	-149750.374	0.191	-41208.071	-40.091	-7870.741561	6003642.244034	270-11-31	179-52-32	14.021
21-104	-149750.327	0.114	-41222.092	-23.961	-4699.318488	3588167.585247	270-23-10	180-11-39	9.940
21-28	-149750.260	0.147	-41232.032	-22.054	-6061.108704	3302592.234040	270-22-42	179-59-32	12.114
21-13	-149750.180	0.202	-41244.146	-30.124	-8331.317492	4511074.422320	270-23-17	180-00-35	18.010
21-103	-149750.058	0.133	-41262.156	-24.842	-5487.866748	3720090.940836	270-05-32	179-42-15	6.832
21-102	-149750.047	0.015	-41268.988	-8.601	-619.034820	1288000.154247	270-07-46	180-02-14	1.769
合計				倍面積 面積	11395.914102 5697.95	-11395.914102 5697.95			311.231

地番	筆種別	面積	坪数
21-1	筆界	1619.12	489.78
21-2	筆界	383.31	115.95
21-3	筆界	389.65	117.87
21-4	筆界	69.76	21.10
21-5	筆界	2018.46	610.58
21-6	筆界	863.06	261.07
21-7	筆界	83.19	25.16
21-8	筆界	97.84	29.59
21-9	筆界	108.48	32.81
21-10	筆界	65.06	19.68
	筆合計	5697.93	1723.59

面積 (座標法) 計算書

地番 = 21-1  
測点名

	[1] X (i)	[2] X (i+1)-X (i-1)	[3] Y (i)	[4] Y (i+1)-Y (i-1)	[2] * [3]	[1] * [4]	方向角	夾角	距離
21-24K	-149789.514	24.580	-41223.395	49.489	-1013271.049100	-7412933.258346	0-18-56	89-59-05	24.865
21-22K	-149764.649	24.914	-41223.258	-8.729	-1027036.249812	1307295.621121	270-19-00	90-00-04	8.866
21-30	-149764.600	0.146	-41232.124	-20.971	-6019.890104	3140713.426600	270-27-33	180-08-33	12.105
21-21	-149764.503	14.420	-41244.229	-12.022	-594741.782180	1800468.855066	0-19-55	269-52-22	14.323
21-13	-149750.180	14.445	-41244.146	-17.927	-595771.688970	2684571.476860	270-23-17	90-03-22	18.010
21-103	-149750.058	0.133	-41262.156	-24.842	-5487.866748	3720090.940836	270-05-32	179-42-15	6.832
21-102	-149750.047	0.015	-41268.988	-8.601	-619.034820	1288000.154247	270-07-46	180-02-14	1.769
21-101	-149750.043	-0.995	-41270.757	-2.800	41064.403215	419300.120400	225-54-11	135-46-25	1.436
21-100	-149751.042	-39.186	-41271.788	-1.990	1617276.284568	298004.573580	181-26-19	135-32-08	38.199
21-20K	-149789.229	-38.472	-41272.747	48.393	1587845.122584	-7248750.158997	90-19-51	88-53-32	49.353
合計				倍面積 面積	3238.248633 1619.12	-3238.248633 1619.12			175.758

面積 (座標法) 計算書

地番 = 21-2  
測点名

	[1] X (i)	[2] X (i+1)-X (i-1)	[3] Y (i)	[4] Y (i+1)-Y (i-1)	[2] * [3]	[1] * [4]	方向角	夾角	距離
21-14K	-149750.389	14.375	-41205.312	-2.679	-592326.360000	401181.292131	270-18-41	89-59-32	2.759
21-105	-149750.374	0.062	-41208.071	-16.780	-2554.900402	2512811.275720	270-11-31	179-52-50	14.021
21-104	-149750.327	0.114	-41222.092	-23.961	-4699.318488	3588167.585247	270-23-10	180-11-39	9.940
21-28	-149750.260	-14.273	-41232.032	-10.032	588504.792736	1502294.608320	180-22-03	89-58-53	14.340
21-30	-149764.600	-14.489	-41232.124	26.640	597412.244636	-3989728.944000	90-19-10	89-57-07	26.732
21-29K	-149764.749	14.211	-41205.392	26.812	-585569.825712	-4015492.450188	0-19-09	89-59-59	14.360
合計				倍面積 面積	766.632770 383.31	-766.632770 383.31			82.152

面積 (座標法) 計算書

地番 = 21-3  
測点名

	[1] X (i)	[2] X (i+1)-X (i-1)	[3] Y (i)	[4] Y (i+1)-Y (i-1)	[2] * [3]	[1] * [4]	方向角	夾角	距離
21-15	-149750.570	14.382	-41178.189	-3.761	-592224.714198	563211.893770	270-46-54	90-34-40	3.812
21-107	-149750.518	0.181	-41182.001	-27.123	-7453.942181	4061683.299714	270-19-01	179-32-07	23.311
21-14K	-149750.389	-14.231	-41205.312	-23.391	586392.795072	3502811.349099	180-19-09	90-00-08	14.360
21-29K	-149764.749	-14.511	-41205.392	27.072	597931.443312	-4054431.284928	90-19-07	89-59-58	27.152
21-23K	-149764.900	14.179	-41178.240	27.203	-583866.264960	-4074054.574700	0-12-14	89-53-07	14.330
合計				倍面積 面積	779.317045 389.65	-779.317045 389.65			82.965

面積 (座標法) 計算書

地番 = 21-4  
測点名

	[1] X (i)	[2] X (i+1)-X (i-1)	[3] Y (i)	[4] Y (i+1)-Y (i-1)	[2]*[3]	[1]*[4]	方向角	夾角	距離
21-15	-149750.570	-14.287	-41178.189	-5.011	588312.786243	750400.106270	180-12-14	89-42-26	14.330
21-23K	-149764.900	-14.357	-41178.240	4.731	591195.991680	-708537.741900	90-19-25	90-07-11	4.782
21-16	-149764.927	14.287	-41173.458	5.011	-588245.194446	-750472.049197	0-55-00	90-35-35	14.316
21-10	-149750.613	-14.357	-41173.229	-4.731	-591124.048753	-708470.150103	270-29-48	89-34-48	4.960
合計					139.534724	-139.534724			38.388
				倍面積 面積	69.76	69.76			

面積 (座標法) 計算書

地番 = 21-5  
測点名

	[1] X (i)	[2] X (i+1)-X (i-1)	[3] Y (i)	[4] Y (i+1)-Y (i-1)	[2]*[3]	[1]*[4]	方向角	夾角	距離
21-17	-149808.016	-38.834	-41223.497	46.157	1600873.282498	-6914688.594512	84-25-11	84-06-14	46.617
21-6	-149803.483	7.810	-41177.101	49.444	-321593.158810	-7406883.413452	42-55-35	138-30-24	4.475
21-5	-149800.206	6.701	-41174.053	3.085	-275907.329153	-462133.635510	0-37-09	137-41-34	3.424
21-108	-149796.782	35.279	-41174.016	0.595	-1452578.110464	-89129.085290	1-00-13	180-23-04	31.860
21-16	-149764.927	32.133	-41173.458	-49.242	-1323026.725914	7374724.535334	270-19-11	89-18-58	49.801
21-22K	-149764.649	-43.089	-41223.258	-50.039	1776268.963962	7494073.271311	180-18-57	89-59-46	43.368
合計					4036.922119	-4036.922119			179.545
				倍面積 面積	2018.46	2018.46			

面積 (座標法) 計算書

地番 = 21-6  
測点名

	[1] X (i)	[2] X (i+1)-X (i-1)	[3] Y (i)	[4] Y (i+1)-Y (i-1)	[2]*[3]	[1]*[4]	方向角	夾角	距離
21-19	-149790.914	-8.227	-41272.789	-43.863	339551.235103	6570278.860782	181-17-01	90-57-11	8.481
21-112	-149799.393	-21.474	-41272.979	-0.515	886295.951046	77146.687395	181-25-58	180-08-57	12.999
21-11	-149812.388	-13.423	-41273.304	0.130	554011.559592	-19475.610440	133-14-55	131-48-57	0.625
21-7	-149812.816	-0.170	-41272.849	3.284	7016.384330	-491985.287744	84-47-21	131-32-26	2.841
21-110	-149812.558	4.239	-41270.020	43.627	-174943.614780	-6535872.467866	84-25-37	179-38-16	40.992
21-18	-149808.577	21.392	-41229.222	40.904	-881975.517024	-6127770.033608	0-20-56	95-55-19	17.411
21-25	-149791.166	17.663	-41229.116	-43.567	-728229.875908	6525951.729122	270-19-50	89-58-54	43.674
合計					1726.122359	-1726.122359			127.023
				倍面積 面積	863.06	863.06			

面積 (座標法) 計算書

地番 = 21-7  
測点名

	[1] X (i)	[2] X (i+1)-X (i-1)	[3] Y (i)	[4] Y (i+1)-Y (i-1)	[2]*[3]	[1]*[4]	方向角	夾角	距離
21-20K	-149789.229	-1.400	-41272.747	-49.394	57781.845800	7398689.177226	181-25-40	91-05-49	1.686
21-19	-149790.914	-1.937	-41272.789	43.631	79945.392293	-6535527.368734	90-19-50	88-54-10	43.674
21-25	-149791.166	-0.285	-41229.116	49.385	11750.298060	-7397436.732910	90-19-52	180-00-02	5.712
21-27K	-149791.199	1.652	-41223.404	5.721	-68101.063408	-856955.449479	0-18-22	89-58-30	1.685
21-24K	-149789.514	1.970	-41223.395	-49.343	-81210.088150	7391063.989302	270-19-51	90-01-29	49.353
合計					166.384595	-166.384595			102.110
				倍面積 面積	83.19	83.19			

面積 (座標法) 計算書

地番 = 21-8

測点名	[1] X (i)	[2] X (i+1)-X (i-1)	[3] Y (i)	[4] Y (i+1)-Y (i-1)	[2] * [3]	[1] * [4]	方向角	夾角	距離
21-25	-149791.166	-17.378	-41229.116	-5.818	716479.577848	871485.003788	180-20-56	90-01-04	17.411
21-18	-149808.577	-16.850	-41229.222	5.619	694712.390700	-841774.394163	84-24-12	84-03-16	5.752
21-17	-149808.016	17.378	-41223.497	5.818	-716381.930866	-871583.037088	0-19-01	95-54-49	16.817
21-27K	-149791.199	16.850	-41223.404	-5.619	-694614.357400	841676.747181	270-19-52	90-00-51	5.712
合計				倍面積 面積	195.680282 97.84	-195.680282 97.84			45.692

面積 (座標法) 計算書

地番 = 21-9

測点名	[1] X (i)	[2] X (i+1)-X (i-1)	[3] Y (i)	[4] Y (i+1)-Y (i-1)	[2] * [3]	[1] * [4]	方向角	夾角	距離
21-33K	-149750.231	14.384	-41236.575	-7.488	-593146.894800	1121329.729728	270-23-09	90-03-15	7.571
21-13	-149750.180	-14.272	-41244.146	-7.654	588636.451712	1146187.877720	180-19-55	89-56-46	14.323
21-21	-149764.503	-14.384	-41244.229	7.488	593256.989936	-1121436.598464	90-27-42	90-07-47	7.571
21-32K	-149764.564	14.272	-41236.658	7.654	-588529.582976	-1146297.972856	0-19-54	89-52-12	14.333
合計				倍面積 面積	216.963872 108.48	-216.963872 108.48			43.798

面積 (座標法) 計算書

地番 = 21-10

測点名	[1] X (i)	[2] X (i+1)-X (i-1)	[3] Y (i)	[4] Y (i+1)-Y (i-1)	[2] * [3]	[1] * [4]	方向角	夾角	距離
21-32K	-149764.564	-14.369	-41236.658	4.451	592529.538802	-666602.074364	90-27-18	90-07-24	4.534
21-30	-149764.600	14.304	-41232.124	4.626	-589784.301696	-692811.039600	0-22-03	89-54-45	14.340
21-28	-149750.260	14.369	-41232.032	-4.451	-592463.067808	666538.407260	270-21-57	89-59-54	4.543
21-33K	-149750.231	-14.304	-41236.575	-4.626	589847.968800	692744.568606	180-19-54	89-57-57	14.333
合計				倍面積 面積	130.138098 65.06	-130.138098 65.06			37.750