

8 0 B L O C K

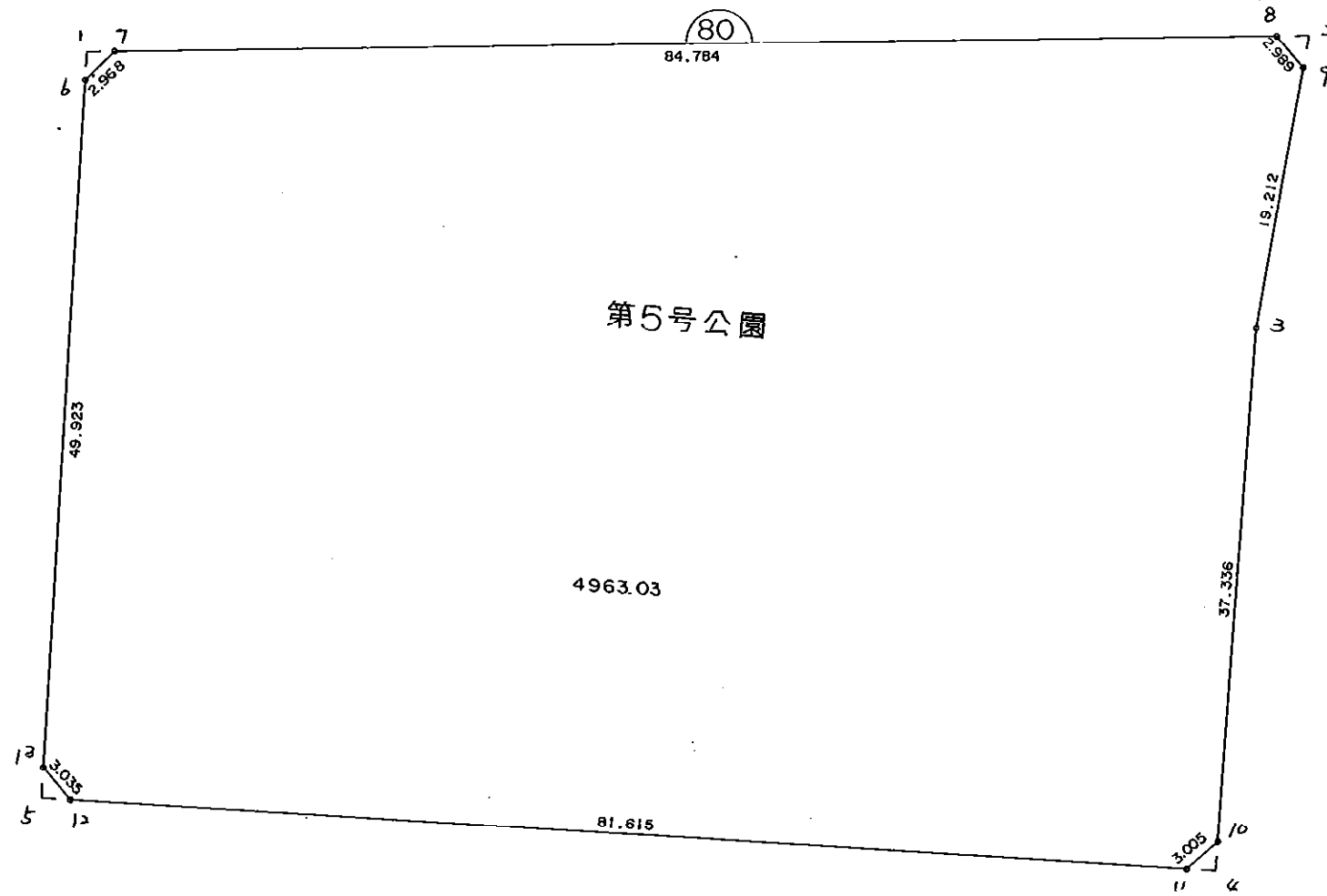

\* \* \* 各筆面積 集計表 \* \* \*

街区名・筆名	各筆面積	隅切面積
80 BLOCK	4963.03	
5 コウコウエシ	4963.03	
1 スミキリ		2.03
2 スミキリ		2.72
4 スミキリ		2.21
5 スミキリ		2.30
合計 =	4963.03	9.26

\* \* \* \* \* 各 筆 面 積 計 算 書 \* \* \* \* \*

80 BLOCK

点 名	X	Y	(X-X0)*(YN-1-Y0)	(XN-1-X0)*(Y-Y0)
X0-Y0	- 151100.000	- 39300.000		
80-6	- 151124.297	- 39468.148		
80-7	- 151122.084	- 39466.170	+ 3713.380432	+ 4037.432490
80-8	- 151114.105	- 39381.763	+ 2343.827850	+ 1805.654092
80-9	- 151116.227	- 39379.658	+ 1326.768201	+ 1123.576090
80-3	- 151135.337	- 39381.630	+ 2814.874746	+ 1324.610010
80-10	- 151172.673	- 39381.550	+ 5932.296990	+ 2881.732350
80-11	- 151174.808	- 39383.664	+ 6100.592400	+ 6080.113872
80-12	- 151176.371	- 39465.263	+ 6389.503344	+ 12362.994504
80-13	- 151174.214	- 39467.398	+ 12264.828282	+ 12784.352658
80-6	- 151124.297	- 39468.148	+ 4067.269206	+ 12478.935672
			+ 44953.341451	+ 54879.401738
		倍面積	= 9926.060287	
		面積	= 4963.030143	

5 コウコウエシ

点 名	X	Y	(X-X0)*(YN-1-Y0)	(XN-1-X0)*(Y-Y0)
X0-Y0	- 151100.000	- 39300.000		
80-6	- 151124.297	- 39468.148		
80-7	- 151122.084	- 39466.170	+ 3713.380432	+ 4037.432490
80-8	- 151114.105	- 39381.763	+ 2343.827850	+ 1805.654092
80-9	- 151116.227	- 39379.658	+ 1326.768201	+ 1123.576090
80-3	- 151135.337	- 39381.630	+ 2814.874746	+ 1324.610010
80-10	- 151172.673	- 39381.550	+ 5932.296990	+ 2881.732350
80-11	- 151174.808	- 39383.664	+ 6100.592400	+ 6080.113872
80-12	- 151176.371	- 39465.263	+ 6389.503344	+ 12362.994504
80-13	- 151174.214	- 39467.398	+ 12264.828282	+ 12784.352658
80-6	- 151124.297	- 39468.148	+ 4067.269206	+ 12478.935672
			+ 44953.341451	+ 54879.401738
		倍面積	= 9926.060287	
		面積	= 4963.030143	

1 区切り

点 名	X	Y	(X-X0)*(YN-1-Y0)	(XN-1-X0)*(Y-Y0)
X0-Y0	- 151100.000	- 39400.000		
80-1	- 151122.274	- 39468.178		
80-6	- 151124.297	- 39468.148	+ 1656.520866	+ 1517.928552
80-7	- 151122.084	- 39466.170	+ 1504.980432	+ 1607.732490
80-1	- 151122.274	- 39468.178	+ 1473.870580	+ 1505.642952
			+ 4635.371878	+ 4631.303994
		倍面積	= 4.067884	
		面積	= 2.033942	

\* \* \* \* \* 各 筆 面 積 計 算 書 \* \* \* \* \*

2 筆目

点 名	X	Y	(X-X0)*(YN-1-Y0)	(XN-1-X0)*(Y-Y0)
X0-Y0	- 151100.000	- 39300.000		
80-2	- 151113.883	- 39379.416		
80-8	- 151114.105	- 39381.763	+ 1120.162680	+ 1135.115729
80-9	- 151116.227	- 39379.658	+ 1326.768201	+ 1123.576090
80-2	- 151113.883	- 39379.416	+ 1105.892014	+ 1288.683432
			+ 3552.822895	+ 3547.375251
		倍面積	= 5.447644	
		面積	= 2.723822	

4 筆目

点 名	X	Y	(X-X0)*(YN-1-Y0)	(XN-1-X0)*(Y-Y0)
X0-Y0	- 151100.000	- 39300.000		
80-4	- 151174.767	- 39381.546		
80-10	- 151172.673	- 39381.550	+ 5926.192458	+ 6097.248850
80-11	- 151174.808	- 39383.664	+ 6100.592400	+ 6080.113872
80-4	- 151174.767	- 39381.546	+ 6255.306288	+ 6100.293168
			+ 18282.091146	+ 18277.655890
		倍面積	= 4.435256	
		面積	= 2.217628	

5 筆目

点 名	X	Y	(X-X0)*(YN-1-Y0)	(XN-1-X0)*(Y-Y0)
X0-Y0	- 151100.000	- 39400.000		
80-5	- 151176.411	- 39467.365		
80-12	- 151176.371	- 39465.263	+ 5144.732415	+ 4986.811093
80-13	- 151174.214	- 39467.398	+ 4843.428282	+ 5147.252658
80-5	- 151176.411	- 39467.365	+ 5149.948578	+ 4999.426110
			+ 15138.109275	+ 15133.489861
		倍面積	= 4.619414	
		面積	= 2.309707	