

1 街区

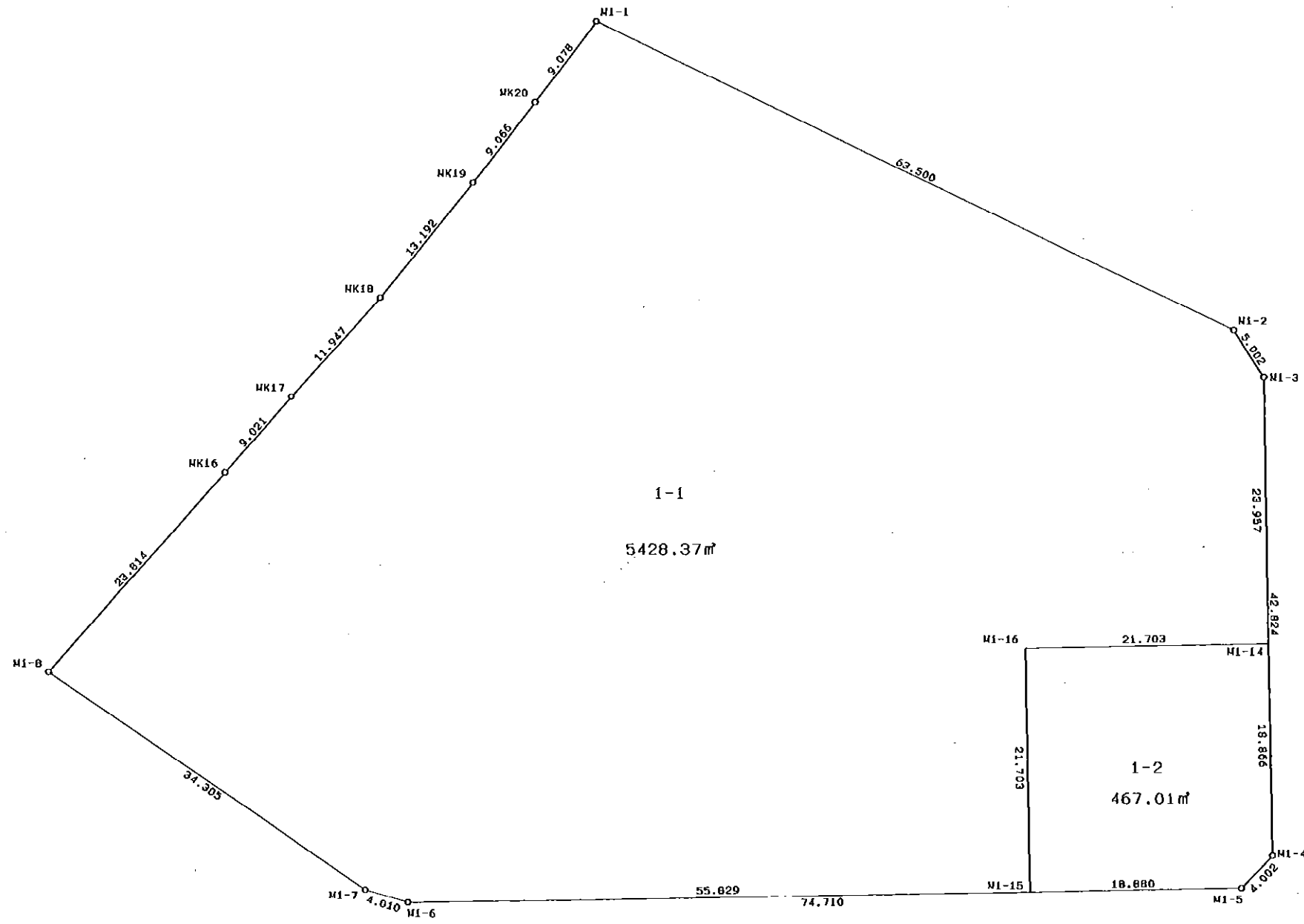
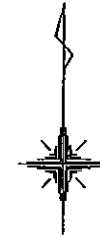

S=1:500

* * 面積計算 (座標法) * *

地 器械点	番 : 1 視準点	内角	方向角	距離	[1] X(i)	[2] Y(i)	[3] X(i+1)-X(i-1)	[2]*[3]
M1-1	MK20	101-36-01	217-11-49	9.078	-148423.818	-37880.547	20.203	--765300.691041
MK20	MK19	180-32-06	217-43-55	9.066	-148431.049	-37886.035	-14.401	545596.790035
MK19	MK18	181-01-39	218-45-34	13.192	-148438.219	-37891.583	-17.457	661473.364431
MK18	MK17	183-18-58	222-04-32	11.947	-148448.506	-37899.842	-19.155	725971.473510
MK17	MK16	179-02-28	221-07-00	9.021	-148457.374	-37907.848	-15.664	593788.531072
MK16	M1-8	179-54-59	221-01-59	23.814	-148464.170	-37913.780	-24.760	938745.192800
M1-8	M1-7	83-16-30	124-18-29	34.305	-148482.134	-37929.414	-37.300	1414767.142200
M1-7	M1-6	162-04-30	106-22-59	4.010	-148501.470	-37901.077	-20.467	775721.342959
M1-6	M1-5	162-31-04	88-54-03	74.710	-148502.601	-37897.230	0.302	-11444.963460
M1-5	M1-4	134-51-50	43-45-53	4.002	-148501.168	-37822.534	4.323	-163506.814482
M1-4	M1-3	135-08-56	358-54-49	42.824	-148498.278	-37819.766	45.706	-1728590.224796
M1-3	M1-2	148-24-12	327-19-01	5.002	-148455.462	-37820.578	47.026	-1778550.501028
M1-2	M1-1	148-16-47	295-35-48	63.500	-148451.252	-37823.279	31.644	-1196879.840676
							倍面積	11790.801524
							面積	5895.400762

* * 面積計算 (座標法) * *

地 器械点	番 : 1-1 視準点	内角	方向角	距離	[1] X(i)	[2] Y(i)	[3] X(i+1)-X(i-1)	[2]*[3]
M1-1	MK20	101-36-01	217-11-49	9.078	-148423.818	-37880.547	20.203	-765300.691041
MK20	MK19	180-32-06	217-43-55	9.066	-148431.049	-37886.035	-14.401	545596.790035
MK19	MK18	181-01-39	218-45-34	13.192	-148438.219	-37891.583	-17.457	661473.364431
MK18	MK17	183-18-58	222-04-32	11.947	-148448.506	-37899.842	-19.155	725971.473510
MK17	MK16	179-02-28	221-07-00	9.021	-148457.374	-37907.848	-15.664	593788.531072
MK16	M1-8	179-54-59	221-01-59	23.814	-148464.170	-37913.780	-24.760	938745.192800
M1-8	M1-7	83-16-30	124-18-29	34.305	-148482.134	-37929.414	-37.300	1414767.142200
M1-7	M1-6	162-04-30	106-22-59	4.010	-148501.470	-37901.077	-20.467	775721.342959
M1-6	M1-15	162-31-04	88-54-03	55.829	-148502.601	-37897.230	-0.060	2273.833800
M1-15	M1-16	90-00-41	358-54-44	21.703	-148501.530	-37841.411	22.770	-861648.928470
M1-16	M1-14	269-59-22	88-54-06	21.703	-148479.831	-37841.823	22.115	-836871.915645
M1-14	M1-3	90-00-45	358-54-51	23.957	-148479.415	-37820.124	24.369	-921638.601756
M1-3	M1-2	148-24-10	327-19-01	5.002	-148455.462	-37820.578	28.163	-1065140.938214
M1-2	M1-1	148-16-47	295-35-48	63.500	-148451.252	-37823.279	31.644	-1196879.840676
							倍面積	10856.755005
							面積	5428.377503

* * 面積計算 (座標法) * *

地 器械点	番 : 1-2 視準点	内角	方向角	距離	[1] X(i)	[2] Y(i)	[3] X(i+1)-X(i-1)	[2]*[3]
M1-15	M1-5	89-59-21	88-54-05	18.880	-148501.530	-37841.411	-21.337	807422.186507
M1-5	M1-4	134-51-48	43-45-53	4.002	-148501.168	-37822.534	3.252	-122998.880568
M1-4	M1-14	135-08-53	358-54-46	18.866	-148498.278	-37819.766	21.753	-822693.369798
M1-14	M1-16	89-59-20	268-54-06	21.703	-148479.415	-37820.124	18.447	-697667.827428
M1-16	M1-15	90-00-38	178-54-44	21.703	-148479.831	-37841.823	-22.115	836871.915645
							倍面積	934.024358
							面積	467.012179