

C-132

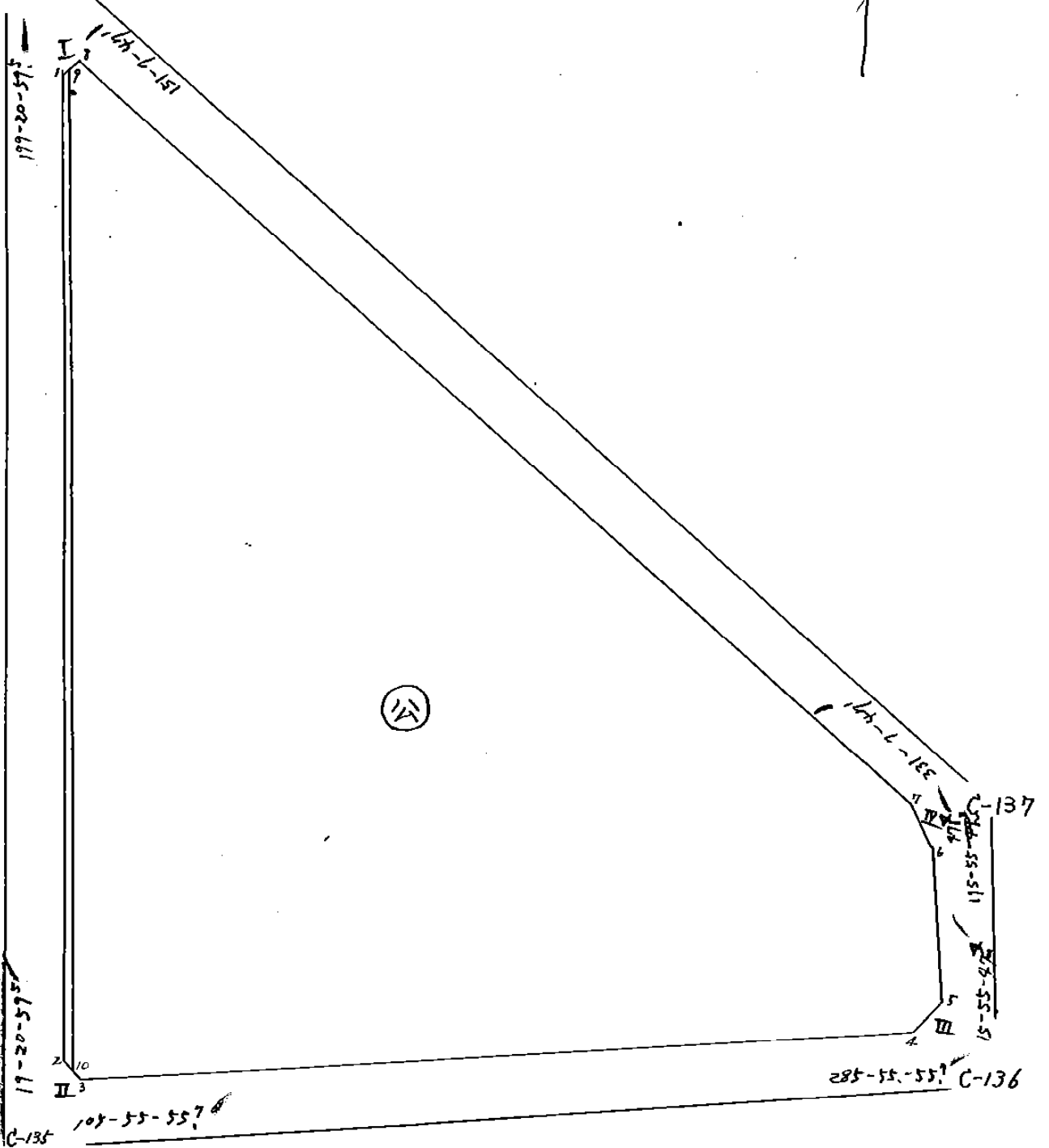

面積計算書

上
区

ブ
ロ
ック

66

計
算
者

精
算
者

備
考

点

	① X	② X - (定数)	③ $X_{n-1} - X_n$	④ Y	⑤ Y - (定数)	⑥ $Y_{n-1} - Y_n$	③ × ⑤ +	⑤ -	② × ⑥ +	⑥ -
		154,100,000			75,700,000					
70	-154 155 693	- 55.693	+ 3.674	-35 703 531	- 3.531	- 0.417		12.9928	23.2339	
6	-154 157 616	+ 57.616	- 1.751	-35 704 080	- 4.020	+ 0.966	7.1440			55.6570
7	-154 153 962	- 53.962	- 1.1283	-35 704 497	- 4.497	- 0.549	8.6499		29.6191	
							15.7919	12.9928	52.8380	55.6570
							2.8187	$\frac{1}{2} = \sqrt{1.4094}$		2.8190
								0.4263		

面積計算書

区

ブロック

66.

計算者

精算者

TABLE

備考

点	①	②	③	④	⑤	⑥	③	⑤	②	⑥
	X	X-(定数) -154,000,000	X _{n-1} -X _n	Y	Y-(定数) -35,700,000	Y _{n-1} -Y _n	+	-	+	-
I	-154,069,076	69,076	-0.136	-35,751,287	51,287	-1.629	6,9950		112,5248	
8	-154,070,827	70,827	+1.887	-35,750,321	50,321	+0.863		94,9557		46,9583
1	-154,070,963	70,963	-1.751	-35,751,950	57,950	+0.966	90,9644			68,5500
							97,9394	94,9557	112,5248	115,5085
							2,9837	1/2 * 1,4918		2,9837
								0.4412		
II	-154,151,644	51,644	-2.436	-35,780,283	70,283	+1.260	195,5673			65,0719
2	-154,149,757	49,757	+0.549	-35,779,620	79,620	-1.923		43,9113	75,6829	
3	-154,152,193	52,193	+1.887	-35,778,360	78,360	+0.663		147,8653		34,6039
							195,5673	171,5766	95,6829	99,6733
							3,7929	1/2 * 1,9963		3,9926
								0.6038		
III	-154,172,208	72,208	+1.374	-35,708,245	8,245	+2.472		11,3286		178,4981
4	-154,171,659	71,659	-1.923	-35,710,168	10,168	-0.549	19,5530		39,3407	
5	-154,170,285	70,285	+0.549	-35,707,696	7,696	-1.923		4,2251	135,1580	
							19,5530	15,5337	174,4987	178,4981
							3,9992	1/2 * 1,9996		3,9994
								0.6048		

面積計算書

区

ブロック

66.

計測者

精算者

TAKAYA

備

点 公	①	②	③	④	⑤	⑥	③ × ⑤		② × ⑥	
	X	X-(定数)	X _{n-1} -X _n	Y	Y-(定数)	Y _{n-1} -Y _n	+	-	+	-
		-154.000.000			-35.700.000					
8	^{070 827} -154 231 009	70.827	- 83.088	^{750 321} -35 972 257	50.321	+ 46.143	4181.0712			3268.1702
9	-154 070 854	70.854	+ 80.394	-35 750 640	50.640	+ 28.542		4071.1521		2022.3148
10	-154 151 221	151.221	+ 81.339	-35 778 863	78.863	+ 27.720		6414.6375		4191.8461
3	-154 152 193	152.193	+ 20.438	-35 778 360	78.360	- 68.695		1601.3216	10454.8981	
4	-154 171 659	171.659	+ 18.092	-35 710 168	10.168	- 70.664		1183.9594	12130.1115	
5	-154 170 285	170.285	- 14.043	-35 707 696	7.696	- 6.028	108.0749		+1036.6950	
6	-154 157 616	157.616	- 16.343	-35 702 080	4.080	- 3.199	66.6994		504.2135	
7	-154 153 942	153.942	- 36.789	-35 704 497	4.497	+ 46.241	390.2901			7118.4320
		-154.000.000			-35.700.000		4746.7156	12271.2906	24125.9181	16600.7631
							9525.1550	1/2 = 3762.5975		9525.1550
								1128.1796		
1. E	-154 070 963	70.963	+ 78.903	-35 751 950	51.950	+ 28.980		4099.0108		2056.5097
2	-154 149 757	149.757	+ 80.261	-35 779 620	79.620	+ 26.913		6390.1419		4030.4101
								6390.3808		
10	-154 151 221	151.221	- 28.903	-35 778 863	78.863	- 28.980	6222.5272		4382.3845	
9	-154 070 854	70.854	- 80.261	-35 750 640	50.640	- 26.913	4064.2651		1906.8937	
							4264.4170			
							10286.7442	10489.5976	6289.2982	8086.9198
							202.3604	1/2 = 101.1802		202.3604
								30.6070		202.3604