

407-007
 杭打図 S=1:500

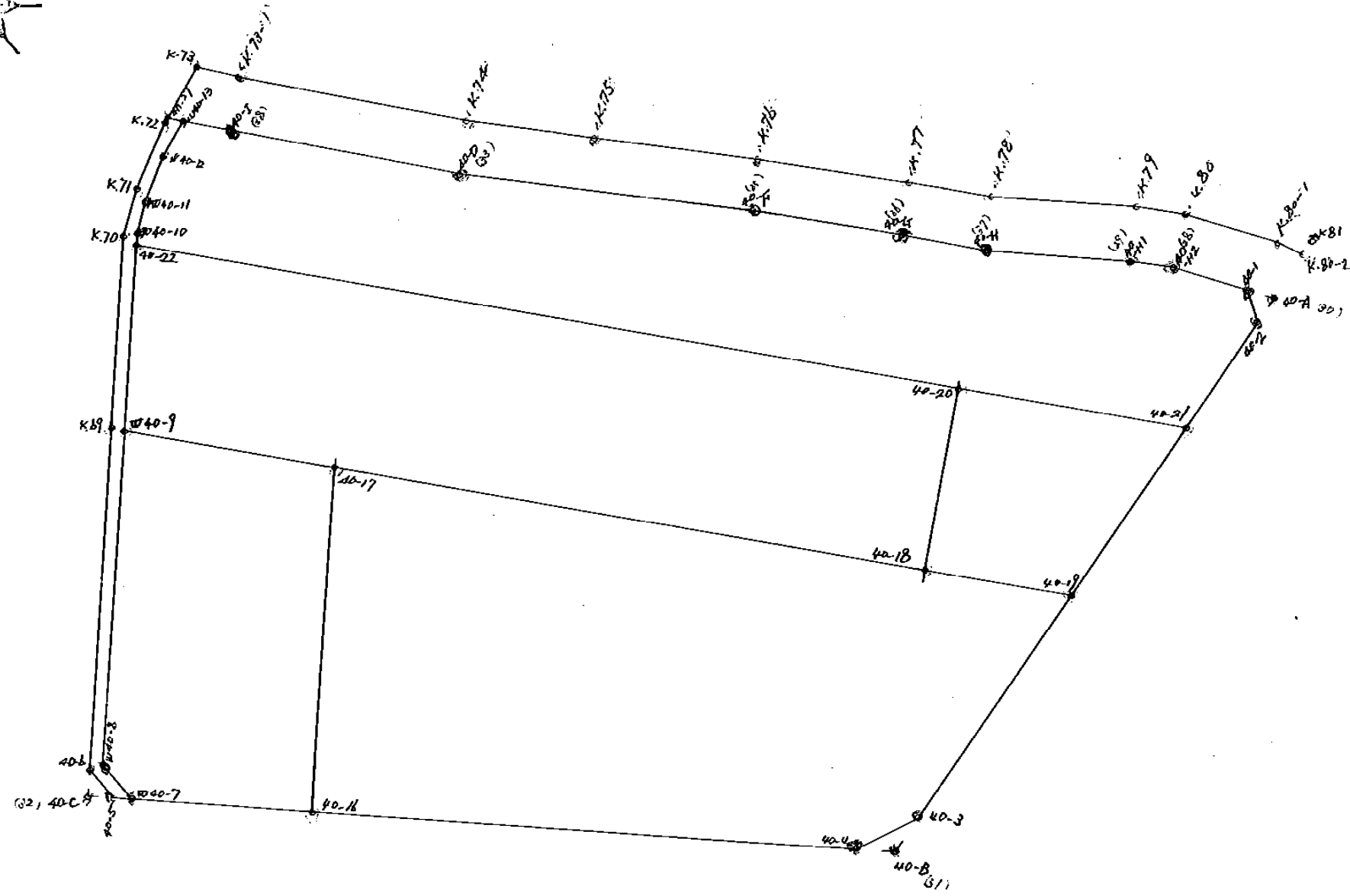

凡	例
ペンキ	◎
ラベル	○
鉄	○
コンクリート杭	○
木杭	○

40 ブロック

** 倍横距法面積計算 **

観測点	挟角	方向角	距離	緯距	経距	X	Y	測点	倍横距	倍面積
()40-2	128-56-19	343-01-26	2.497	2.388	-0.729	-151,680.909	-38,807.172	()40-1	-0.729	-1.740852
()40-1	123-02-37	286-04-03	5.925	1.640	-5.694	-151,679.269	-38,812.866	()40-28	-7.152	-11.729280
()40-28	172-41-03	278-45-06	3.247	0.494	-3.209	-151,678.775	-38,816.075	()40-29	-16.055	-7.931170
()40-29	174-58-05	273-43-11	10.744	0.697	-10.721	-151,678.078	-38,826.796	()40-37	-29.985	-20.899545
()40-37	185-56-00	279-39-11	6.518	1.093	-6.426	-151,676.985	-38,833.222	()40-36	-47.132	-51.515276
()40-36	178-29-41	278-08-52	11.416	1.618	-11.301	-151,675.367	-38,844.523	()40-35	-64.859	-104.941862
()40-35	178-44-40	276-53-32	22.217	2.666	-22.056	-151,672.701	-38,866.579	()40-33	-98.216	-261.843856
()40-33	183-12-32	280-06-04	17.447	3.060	-17.177	-151,669.641	-38,883.756	()40-38	-137.449	-420.593940
()40-38	180-40-09	280-46-13	3.623	0.677	-3.559	-151,668.964	-38,887.315	W.40-13	-158.185	-107.091245
W.40-13	110-26-04	211-12-17	3.140	-2.686	-1.627	-151,671.650	-38,888.942	W.40-12	-163.371	438.814506
W.40-12	170-14-12	201-26-29	3.666	-3.412	-1.340	-151,675.062	-38,890.282	W.40-11	-166.338	567.545256
W.40-11	172-41-09	194-07-38	2.446	-2.372	-0.597	-151,677.434	-38,890.879	W.40-10	-168.275	399.148300
W.40-10	169-00-41	183-08-19	14.684	-14.662	-0.804	-151,692.096	-38,891.683	W.40-15	-169.676	2487.789512
W.40-15	96-26-08	99-34-27	0.085	-0.014	0.083	-151,692.110	-38,891.600	W.40-9	-170.397	2.385558
W.40-9	263-37-34	183-12-01	25.077	-25.038	-1.400	-151,717.148	-38,893.000	W.40-8	-171.714	4299.375132
W.40-8	135-10-13	138-22-14	3.428	-2.562	2.277	-151,719.710	-38,890.723	W.40-7	-170.837	437.684394
W.40-7	134-56-17	93-18-31	54.511	-3.146	54.420	-151,722.856	-38,836.303	()40-4	-114.140	359.084440
()40-4	150-11-07	63-29-38	5.214	2.327	4.666	-151,720.529	-38,831.637	()40-3	-55.054	-128.110658
()40-3	150-35-29	34-05-07	44.955	37.232	25.194	-151,683.297	-38,806.443	()40-2	-25.194	-938.023008
TOTAL	3060-00-00		240.839						合計	6937.406406
									面積	3468.7032030

新 958-1 宅地

** 倍横距法面積計算 **

観測点	挟角	方向角	距離	緯距	経距	X	Y	測点	倍横距	倍面積
()40-2	128-56-12	343-01-26	2.497	2.388	-0.729	-151,680.909	-38,807.172	()40-1	-0.729	-1.740852
()40-1	123-02-37	286-04-03	5.925	1.640	-5.694	-151,679.269	-38,812.866	()40-28	-7.152	-11.729280
()40-28	172-41-03	278-45-06	3.247	0.494	-3.209	-151,678.775	-38,816.075	()40-29	-16.055	-7.931170
()40-29	174-58-05	273-43-11	10.744	0.697	-10.721	-151,678.078	-38,826.796	()40-37	-29.985	-20.899545
()40-37	185-56-00	279-39-11	6.518	1.093	-6.426	-151,676.985	-38,833.222	()40-36	-47.132	-51.515276
()40-36	178-29-41	278-08-52	11.416	1.618	-11.301	-151,675.367	-38,844.523	()40-35	-64.859	-104.941862
()40-35	178-44-40	276-53-32	22.217	2.666	-22.056	-151,672.701	-38,866.579	()40-33	-98.216	-261.843856
()40-33	183-12-32	280-06-04	17.447	3.060	-17.177	-151,669.641	-38,883.756	()40-38	-137.449	-420.593940
()40-38	180-40-09	280-46-13	3.623	0.677	-3.559	-151,668.964	-38,887.315	W. 40-13	-158.185	-107.091245
W. 40-13	110-26-04	211-12-17	3.140	-2.686	-1.627	-151,671.650	-38,888.942	W. 40-12	-163.371	438.814506
W. 40-12	170-14-12	201-26-29	3.666	-3.412	-1.340	-151,675.062	-38,890.282	W. 40-11	-166.338	567.545256
W. 40-11	172-41-09	194-07-38	2.446	-2.372	-0.597	-151,677.434	-38,890.879	W. 40-10	-168.275	399.148300
W. 40-10	169-02-29	183-10-07	0.850	-0.849	-0.047	-151,678.283	-38,890.926	()40-22	-168.919	143.412231
()40-22	95-59-44	99-09-51	62.864	-10.012	62.062	-151,688.295	-38,828.864	()40-20	-106.904	1070.322848
()40-20	180-33-02	99-42-53	17.310	-2.921	17.062	-151,691.216	-38,811.802	()40-21	-27.780	81.145380
()40-21	114-22-21	34-05-14	9.562	7.919	5.359	-151,683.297	-38,806.443	()40-2	-5.359	-42.437921
TOTAL	2520-00-00		183.472						合計	1669.663574
									面積	834.8317870

新 959-3 宅地

** 倍横距法面積計算 **

観測点	挟角	方向角	距離	緯距	経距	X	Y	測点	倍横距	倍面積
()40-22	83-58-22	183-08-13	13.834	-13.813	-0.757	-151,692.096	-38,891.683	W. 40-15	-0.757	10.456441
W. 40-15	96-03-14	99-11-27	16.235	-2.593	16.026	-151,694.689	-38,875.657	()40-17	14.512	-37.629616
()40-17	180-08-19	99-19-46	45.031	-7.300	44.435	-151,701.989	-38,831.222	()40-18	74.973	-547.302900
()40-18	90-26-26	9-46-12	13.896	13.694	2.358	-151,688.295	-38,828.864	()40-20	121.766	1667.463604
()40-20	89-23-39	279-09-51	62.864	10.012	-62.062	-151,678.283	-38,890.926	()40-22	62.062	621.364744
TOTAL	540-00-00		151.859						合計	1714.352273
									面積	857.1761365

新'959-1 / 田

** 倍横距法面積計算 **

観測点	挟角	方向角	距離	緯距	経距	X	Y	測点	倍横距	倍面積
()40-20	90-03-19	189-46-12	13.896	-13.694	-2.358	-151,701.989	-38,831.222	()40-18	-2.358	32.290452
()40-18	89-23-32	99-09-44	11.078	-1.764	10.937	-151,703.753	-38,820.285	()40-19	6.221	-10.973844
()40-19	114-55-17	34-05-01	15.137	12.537	8.483	-151,691.216	-38,811.802	()40-21	25.641	321.461217
()40-21	65-37-52	279-42-53	17.310	2.921	-17.062	-151,688.295	-38,828.864	()40-20	17.062	49.838102
TOTAL	360-00-00		57.421						合計	392.615927
									面積	196.3079635

新 832-1. 田

** 倍横距法面積計算 **

観測点	挟角	方向角	距離	緯距	経距	X	Y	測点	倍横距	倍面積
W. 40-9	84-00-41	183-12-01	25.077	-25.038	-1.400	-151,717.148	-38,893.000	W. 40-8	-1.400	35.053200
W. 40-8	135-10-13	138-22-14	3.428	-2.562	2.277	-151,719.710	-38,890.723	W. 40-7	-0.523	1.339926
W. 40-7	134-56-13	93-18-27	13.658	-0.788	13.635	-151,720.498	-38,877.088	() 40-16	15.389	-12.126532
() 40-16	89-51-58	3-10-25	25.849	25.809	1.431	-151,694.689	-38,875.657	() 40-17	30.455	786.013095
() 40-17	96-00-55	279-11-20	16.150	2.579	-15.943	-151,692.110	-38,891.600	W. 40-9	15.943	41.116997
TOTAL	540-00-00		84.162						合計	851.396686
									面積	425.6983430

新 960-1 田

** 倍横距法面積計算 **

観測点	挟角	方向角	距離	緯距	経距	X	Y	測点	倍横距	倍面積
()40-17	83-50-39	183-10-25	25.849	-25.809	-1.431	-151,720.498	-38,877.088	()40-16	-1.431	36.932679
()40-16	90-08-07	93-18-32	40.853	-2.358	40.785	-151,722.856	-38,836.303	()40-4	37.923	-89.422434
()40-4	150-11-06	63-29-38	5.214	2.327	4.666	-151,720.529	-38,831.637	()40-3	83.374	194.011298
()40-3	150-35-30	34-05-08	20.256	16.776	11.352	-151,703.753	-38,820.285	()40-19	99.392	1667.400192
()40-19	65-04-36	279-09-44	11.078	1.764	-10.937	-151,701.989	-38,831.222	()40-18	99.807	176.059548
()40-18	180-10-02	279-19-46	45.031	7.300	-44.435	-151,694.689	-38,875.657	()40-17	44.435	324.375500
TOTAL	720-00-00		148.281						合計	2309.356783
									面積	1154.6783915

第 11 号水路

** 倍横距法面積計算 **

観測点	挟角	方向角	距離	緯距	経距	X	Y	測点	倍横距	倍面積
()40-27	112-30-39	213-16-30	0.421	-0.352	-0.231	-151,669.093	-38,888.719	K.72	-0.231	0.081312
K.72	169-28-56	202-45-26	5.421	-4.999	-2.097	-151,674.092	-38,890.816	K.71	-2.559	12.792441
K.71	172-45-30	195-30-56	3.589	-3.458	-0.960	-151,677.550	-38,891.776	K.70	-5.616	19.420128
K.70	167-41-19	183-12-15	14.439	-14.416	-0.807	-151,691.966	-38,892.583	K.69	-7.383	106.433328
K.69	95-00-54	98-13-09	0.909	-0.130	0.900	-151,692.096	-38,891.683	W.40-15	-7.290	0.947700
W.40-15	84-55-10	3-08-19	14.684	14.662	0.804	-151,677.434	-38,890.879	W.40-10	-5.586	-81.901932
W.40-10	190-59-19	14-07-38	2.446	2.372	0.597	-151,675.062	-38,890.282	W.40-11	-4.185	-9.926820
W.40-11	187-18-51	21-26-29	3.666	3.412	1.340	-151,671.650	-38,888.942	W.40-12	-2.248	-7.670176
W.40-12	189-45-48	31-12-17	3.140	2.686	1.627	-151,668.964	-38,887.315	W.40-13	0.719	1.931234
W.40-13	69-33-34	280-45-51	1.194	0.223	-1.173	-151,668.741	-38,888.488	()40-27	1.173	0.261579
TOTAL	1440-00-00		49.909						合計	42.368794
									面積	21.1843970

才 8 号水路

** 倍横距法面積計算 **

観測点	挟角	方向角	距離	緯距	経距	X	Y	測点	倍横距	倍面積
K. 69	84-51-08	183-11-10	25.621	-25.581	-1.424	-151,717.547	-38,894.007	()40-6	-1.424	36.427344
()40-6	134-53-10	138-04-20	2.797	-2.081	1.869	-151,719.628	-38,892.138	()40-5	-0.979	2.037299
()40-5	135-14-40	93-19-00	1.417	-0.082	1.415	-151,719.710	-38,890.723	W. 40-7	2.305	-0.189010
W. 40-7	45-03-14	318-22-14	3.428	2.562	-2.277	-151,717.148	-38,893.000	W. 40-8	1.443	3.696966
W. 40-8	224-49-47	3-12-01	25.077	25.038	1.400	-151,692.110	-38,891.600	W. 40-9	0.566	14.171508
W. 40-9	95-08-01	278-20-02	0.993	0.144	-0.983	-151,691.966	-38,892.583	K. 69	0.983	0.141552
TOTAL	720-00-00		59.333						合計	56.285659
									面積	28.1428295