

***** カクヒツ メンセキ シユウケイ ヒヨウ *****

カクヒツ	カクヒツ	カクヒツ	メンセキ	カクヒツ	メンセキ
52 BLOCK		4487.24			
1 LOT		1022.34			
2 LOT		461.70			
3 LOT		461.86	244.23		
4 LOT		148.97	217.61		
5 LOT		668.96			
6 LOT		491.16			
7 LOT		443.41			
8 LOT		594.59			
スィロ 1(スィロ2-6号)		180.15			
スィロ 2(スィロ3号)		14.74			
スィロリ 45		422.58		122.58	
36 スィロリ				4.36	
カクヒツ =		4610.46		4.36	
		4487.88		126.94	

***** カワヒツ メンヒキ ケイリシ *****

59 BLOCK

子ノメ X0.Y0	X	Y	(X-X0)*(YN-1-Y0)	(XN-1-X0)*(Y-Y0)
359-1	- 151800.000	- 37700.000		
K68	- 151879.952	- 37782.173		
K69	- 151905.325	- 37806.912	+ 8654.871225	+ 8547.828224
K70	- 151916.635	- 37816.117	+ 12475.026720	+ 12230.023025
K71	- 151929.974	- 37824.928	+ 15092.190958	+ 14577.223680
K72	- 151941.441	- 37830.665	+ 17669.941248	+ 16983.052710
K73	- 151940.652	- 37834.142	+ 18378.293580	+ 18973.178622
K74	- 151967.531	- 37838.885	+ 22472.943402	+ 19534.453020
K75	- 151974.617	- 37839.514	+ 24251.682045	+ 23372.919934
K76	- 151981.432	- 37840.048	+ 25312.304048	+ 24454.761616
K77	- 151982.748	- 37840.440	+ 25593.491904	+ 25480.310080
359-2	- 151985.121	- 37842.915	+ 25998.393240	+ 26117.430420
359-3	- 151991.352	- 37835.380	+ 27347.071080	+ 25061.680980
359-4	- 152001.545	- 37843.909	+ 27285.162100	+ 27537.274968
359-5	- 152002.274	- 37844.591	+ 29109.049066	+ 29141.593095
359-6	- 152002.975	- 37845.299	+ 29348.358225	+ 29390.209926
359-7	- 152003.642	- 37846.042	+ 29588.978958	+ 29642.874950
359-8	- 152004.247	- 37846.833	+ 29828.640374	+ 29901.365786
359-9	- 152004.774	- 37847.687	+ 30067.580742	+ 30164.626689
359-10	- 152005.248	- 37848.569	+ 30312.461376	+ 30423.068406
359-11	- 152005.670	- 37849.475	+ 30556.186230	+ 30679.444800
359-12	- 152006.037	- 37850.403	+ 30797.380575	+ 30933.385010
359-13	- 152006.329	- 37851.362	+ 31032.500587	+ 31186.172394
359-14	- 152006.562	- 37852.332	+ 31265.637444	+ 31430.509228
359-15	- 152006.736	- 37853.328	+ 31492.508352	+ 31671.738336
359-16	- 152006.838	- 37854.316	+ 31714.056864	+ 31902.672576
359-17	- 152006.873	- 37855.313	+ 31923.813868	+ 32124.630294
359-18	- 152006.836	- 37856.313	+ 32124.319668	+ 32336.939249
359-19	- 152006.743	- 37857.310	+ 32316.618559	+ 32537.371160
359-20	- 152006.585	- 37858.296	+ 32497.886350	+ 32726.589928
359-21	- 152006.349	- 37859.268	+ 32664.221304	+ 32902.379780
359-22	- 152006.051	- 37860.225	+ 32817.330668	+ 33062.268525
359-23	- 152005.706	- 37861.166	+ 32959.243850	+ 33208.415466
359-24	- 152005.302	- 37862.081	+ 33087.702132	+ 33341.034186
359-25	- 152004.825	- 37862.960	+ 33198.240825	+ 33456.013920
359-26	- 152004.234	- 37863.806	+ 33290.120640	+ 33551.563950
359-27	- 152003.694	- 37864.617	+ 33366.299364	+ 33628.619228
359-28	- 152003.061	- 37865.385	+ 33427.292637	+ 33687.932190
359-29	- 152002.367	- 37866.098	+ 33468.466295	+ 33728.025978
359-30	- 152001.629	- 37866.769	+ 33490.173642	+ 33748.542223
359-31	- 152000.838	- 37867.389	+ 33493.552422	+ 33750.476681
359-32	- 152000.009	- 37867.956	+ 33479.306501	+ 33731.947128
359-33	- 151999.152	- 37868.465	+ 33448.773312	+ 33694.516185
359-34	- 151998.441	- 37868.852	+ 33430.363065	+ 33627.213504
359-35	- 151995.014	- 37890.108	+ 26174.423928	+ 27725.221628
359-35	- 151938.037	- 37855.311	+ 26251.443396	+ 24075.379354

***** カクヒツ メンベキ ケイサン *****

アノメイ	X	Y	(X-X0)*(YN-1-Y0)	(XN-1-X0)*(Y-Y0)
059-37	- 151869.529	- 37812.654	+ 10798.618519	+ 15556.052898
059-38	- 151868.260	- 37808.364	+ 7689.762040	+ 7534.440556
059-1	- 151879.952	- 37782.173	+ 8663.918528	+ 5609.128980
			+289706.601855	+298682.501466
		ハイメンベキ	= 8975.899610	
		メンベキ	= 4487.949805	

1 LOT

アノメイ	X	Y	(X-X0)*(YN-1-Y0)	(XN-1-X0)*(Y-Y0)
X0.Y0	- 151800.000	- 37700.000		
059-38	- 151868.260	- 37808.364		
059-1	- 151879.952	- 37782.173	+ 8663.918528	+ 5609.128980
K68	- 151905.325	- 37806.912	+ 8654.871225	+ 8547.828224
1	- 151911.863	- 37812.210	+ 11959.497056	+ 11818.518250
8	- 151900.630	- 37830.250	+ 11291.692300	+ 14570.155750
059-43	- 151868.891	- 37810.497	+ 8973.052750	+ 11119.313110
059-38	- 151868.260	- 37808.364	+ 7542.525220	+ 7465.304324
			+ 57085.557079	+ 59130.248638
		ハイメンベキ	= 2044.691559	
		メンベキ	= 1022.345779	

2 LOT

アノメイ	X	Y	(X-X0)*(YN-1-Y0)	(XN-1-X0)*(Y-Y0)
X0.Y0	- 151900.000	- 37800.000		
8	- 151900.630	- 37830.250		
1	- 151911.863	- 37812.210	+ 358.855750	+ 7.692300
K69	- 151916.685	- 37816.117	+ 203.723850	+ 191.195971
K70	- 151929.974	- 37824.928	+ 483.090958	+ 415.923680
2	- 151930.428	- 37825.155	+ 758.509184	+ 753.995970
7	- 151919.843	- 37842.207	+ 499.150665	+ 1284.274596
8	- 151900.630	- 37830.250	+ 26.590410	+ 600.250750
			+ 2329.920817	+ 3253.333267
		ハイメンベキ	= 923.412450	
		メンベキ	= 461.706225	

3 LOT

アノメイ	X	Y	(X-X0)*(YN-1-Y0)	(XN-1-X0)*(Y-Y0)
X0.Y0	- 151900.000	- 37800.000		
2	- 151919.843	- 37842.207		
2	- 151930.428	- 37825.155	+ 1284.274596	+ 499.150665
K71	- 151941.441	- 37830.665	+ 1042.448355	+ 933.074620
K72	- 151940.652	- 37834.142	+ 1246.593580	+ 1414.878622

***** カワトツ メンベキ ケイリソ *****

アソメイ	X	Y	(X-X0)*(YN-1-Y0)	(XN-1-X0)*(Y-Y0)
3	- 151950.652	- 37835.906	+ 1729.360584	+ 1459.650712
B59-42	- 151939.244	- 37854.282	+ 1409.095064	+ 2749.491864
7	- 151919.843	- 37842.207	+ 1077.117726	+ 1656.371508
			+ 7738.889905	+ 8712.617991
		ハイ メンベキ =	923.728086	
		メンベキ =	461.864043	

4 LOT

アソメイ	X	Y	(X-X0)*(YN-1-Y0)	(XN-1-X0)*(Y-Y0)
X0.Y0	- 151900.000	- 37800.000		
2	- 151949.510	- 37837.746		
3	- 151950.652	- 37835.906	+ 1911.910392	+ 1777.706060
K73	- 151967.531	- 37838.885	+ 2424.768086	+ 1969.603020
K74	- 151974.617	- 37839.514	+ 2901.482045	+ 2668.419934
K75	- 151981.432	- 37840.048	+ 3217.704048	+ 2988.261616
K76	- 151982.748	- 37840.440	+ 3313.891904	+ 3293.110080
10	- 151977.033	- 37847.480	+ 3115.214520	+ 3928.875040
2	- 151949.510	- 37837.746	+ 2350.734800	+ 2907.687618
			+ 19235.705795	+ 19533.663368
		ハイ メンベキ =	297.957573	
		メンベキ =	148.978786	

5 LOT

アソメイ	X	Y	(X-X0)*(YN-1-Y0)	(XN-1-X0)*(Y-Y0)
X0.Y0	- 151900.000	- 37800.000		
10	- 151977.033	- 37847.480		
K76	- 151982.748	- 37840.440	+ 3928.875040	+ 3115.214520
K77	- 151985.121	- 37842.915	+ 3442.293240	+ 3551.130420
B59-39	- 151986.312	- 37843.870	+ 3704.079480	+ 3734.258270
B59-40	- 151992.499	- 37836.339	+ 4057.931130	+ 3136.491768
B59-3	- 152001.545	- 37843.909	+ 3690.043755	+ 4061.538591
B59-4	- 152002.274	- 37844.591	+ 4490.749066	+ 4527.993095
B59-5	- 152002.975	- 37845.299	+ 4591.758225	+ 4632.909926
B59-6	- 152003.642	- 37846.042	+ 4694.878958	+ 4741.174950
B59-7	- 152004.247	- 37846.833	+ 4799.740374	+ 4853.865786
B59-8	- 152004.774	- 37847.687	+ 4906.880742	+ 4971.226689
B59-9	- 152005.248	- 37848.569	+ 5018.961376	+ 5088.768406
B59-10	- 152005.670	- 37849.475	+ 5132.286230	+ 5207.144800
B59-11	- 152006.037	- 37850.403	+ 5246.180575	+ 5326.085010
B59-12	- 152006.329	- 37851.362	+ 5359.300537	+ 5446.272394
B59-13	- 152006.562	- 37852.332	+ 5473.237444	+ 5564.409228
B59-14	- 152006.736	- 37853.328	+ 5585.708352	+ 5682.738336
B59-15	- 152006.878	- 37854.316	+ 5697.456864	+ 5797.472576
B59-16	- 152006.873	- 37855.313	+ 5804.913868	+ 5909.530294

***** カクヒツ メンセキ ケイリョ *****

コマイ	X	Y	(X-X0)*(YN-1-Y0)	(XN-1-X0)*(Y-Y0)
859-17	- 152006.836	- 37856.313	+ 5909.419668	+ 6018.339249
859-18	- 152006.743	- 37857.310	+ 6011.018559	+ 6122.771160
859-19	- 152006.585	- 37858.296	+ 6108.386350	+ 6222.689928
859-20	- 152006.349	- 37859.268	+ 6199.721304	+ 6317.079780
859-21	- 152006.051	- 37860.225	+ 6285.430668	+ 6404.868525
859-22	- 152005.706	- 37861.166	+ 6366.143850	+ 6486.715466
859-23	- 152005.302	- 37862.081	+ 6440.902132	+ 6562.334186
859-24	- 152004.825	- 37862.960	+ 6507.640825	+ 6629.813920
859-25	- 152004.284	- 37863.806	+ 6565.720640	+ 6688.463950
859-26	- 152003.694	- 37864.617	+ 6616.299364	+ 6738.519228
859-27	- 152003.061	- 37865.385	+ 6659.492637	+ 6780.032190
859-28	- 152002.367	- 37866.098	+ 6693.266295	+ 6812.125978
859-29	- 152001.629	- 37866.769	+ 6717.473642	+ 6834.942223
859-30	- 152000.838	- 37867.389	+ 6732.852422	+ 6848.676681
859-31	- 152000.009	- 37867.956	+ 6739.506501	+ 6852.547128
859-32	- 151999.152	- 37868.465	+ 6737.973312	+ 6847.116185
859-33	- 151998.441	- 37868.852	+ 6739.763065	+ 6826.813504
4	- 151989.586	- 37873.186	+ 6168.175272	+ 7204.503026
10	- 151977.033	- 37847.480	+ 5637.737138	+ 4253.543280

+207462.198950 +208800.120646

ハイ メンセキ = 1337.921696
 メンセキ = 668.960848

6 LOT

コマイ	X	Y	(X-X0)*(YN-1-Y0)	(XN-1-X0)*(Y-Y0)
X0.Y0	- 151900.000	- 37800.000		
11	- 151962.256	- 37859.675		
10	- 151977.033	- 37847.480	+ 4596.944275	+ 2955.914880
4	- 151989.586	- 37873.186	+ 4253.543280	+ 5637.737138
5	- 151972.873	- 37881.367	+ 5333.283378	+ 7289.344062
11	- 151962.256	- 37859.675	+ 5065.583952	+ 4348.696275

+ 19249.354885 + 20231.692355

ハイ メンセキ = 982.337470
 メンセキ = 491.168735

7 LOT

コマイ	X	Y	(X-X0)*(YN-1-Y0)	(XN-1-X0)*(Y-Y0)
X0.Y0	- 151900.000	- 37800.000		
6	- 151945.785	- 37867.714		
11	- 151962.256	- 37859.675	+ 4215.602784	+ 2732.219875
5	- 151972.873	- 37881.367	+ 4348.696275	+ 5065.583952
859-41	- 151956.367	- 37889.446	+ 4586.413689	+ 6518.198358
6	- 151945.785	- 37867.714	+ 4095.285110	+ 3816.835038

+ 17245.997858 + 18132.837223

ハイ メンセキ = 886.839365
 メンセキ = 443.419682

***** 与クヒツ ノシセキ ケイリフ *****

3 LOT

アノメイ	X	Y	(X-X0)*(YN-1-Y0)	(XN-1-X0)*(Y-Y0)
X0.Y0	- 151900.000	- 37800.000		
859-42	- 151939.244	- 37854.282		
9	- 151949.510	- 37837.746	+ 2687.501820	+ 1481.304024
10	- 151977.033	- 37847.480	+ 2907.687618	+ 2350.734800
11	- 151962.256	- 37859.675	+ 2955.914880	+ 4596.944275
6	- 151945.785	- 37867.714	+ 2732.219875	+ 4215.602784
859-42	- 151939.244	- 37854.282	+ 2657.368216	+ 2485.301370
			+ 13940.692409	+ 15129.887253
		ハイ ヌシセキ	= 1189.194844	
		ヌシセキ	= 594.597422	

ライン 1 (ライン5号)

アノメイ	X	Y	(X-X0)*(YN-1-Y0)	(XN-1-X0)*(Y-Y0)
X0.Y0	- 151800.000	- 37800.000		
859-37	- 151869.529	- 37812.654		
859-43	- 151868.891	- 37810.497	+ 871.746714	+ 729.845913
859-42	- 151939.244	- 37854.282	+ 1461.644268	+ 3739.541262
859-41	- 151956.367	- 37889.446	+ 8487.913494	+ 12454.818824
859-34	- 151955.014	- 37890.108	+ 13865.382244	+ 14089.917636
859-35	- 151938.087	- 37855.311	+ 12442.743396	+ 8573.979354
859-37	- 151869.529	- 37812.654	+ 3845.718519	+ 1747.352898
			+ 40975.148635	+ 41335.455887
		ハイ ヌシセキ	= 360.307252	
		ヌシセキ	= 180.153626	

ライン 2 (ライン3号)

アノメイ	X	Y	(X-X0)*(YN-1-Y0)	(XN-1-X0)*(Y-Y0)
X0.Y0	- 151900.000	- 37800.000		
K77	- 151985.121	- 37842.915		
859-2	- 151991.352	- 37835.380	+ 3920.371080	+ 3011.580980
859-40	- 151992.499	- 37836.339	+ 3272.614620	+ 3319.640328
859-39	- 151986.312	- 37843.870	+ 3136.491768	+ 4057.931130
K77	- 151985.121	- 37842.915	+ 3734.258270	+ 3704.079480
			+ 14063.735738	+ 14093.231918
		ハイ ヌシセキ	= 29.496180	
		ヌシセキ	= 14.748090	

ライン 45

アノメイ	X	Y	(X-X0)*(YN-1-Y0)	(XN-1-X0)*(Y-Y0)
X0.Y0	- 151900.000	- 37800.000		
859-45	- 152019.207	- 37858.688		
859-33	- 151998.441	- 37868.852	+ 5777.305408	+ 8207.640364

***** リクヒツ メンヒキ ケイリン *****

	アノイ	X	Y	(X-X0)*(YN-1-Y0)	(XN-1-X0)*(Y-Y0)
)	859-32	- 151999.152	- 37868.465	+ 6826.813504	+ 6739.763065
)	859-31	- 152000.009	- 37867.956	+ 6847.116185	+ 6737.973312
)	859-30	- 152000.838	- 37867.389	+ 6852.547128	+ 6739.506501
)	859-29	- 152001.629	- 37866.769	+ 6848.676681	+ 6732.852422
)	859-28	- 152002.367	- 37866.098	+ 6834.942223	+ 6717.473642
)	859-27	- 152003.061	- 37865.385	+ 6812.125978	+ 6693.266295
)	859-26	- 152003.694	- 37864.617	+ 6780.032190	+ 6659.492637
)	859-25	- 152004.284	- 37863.806	+ 6738.519228	+ 6616.299364
)	859-24	- 152004.825	- 37862.960	+ 6688.463950	+ 6565.720640
)	859-23	- 152005.302	- 37862.081	+ 6629.813920	+ 6507.640825
)	859-22	- 152005.706	- 37861.166	+ 6562.334186	+ 6440.902132
)	859-21	- 152006.051	- 37860.225	+ 6486.715466	+ 6366.143850
)	859-20	- 152006.349	- 37859.268	+ 6404.868525	+ 6285.430668
)	859-19	- 152006.585	- 37858.296	+ 6317.079780	+ 6199.721304
)	859-18	- 152006.743	- 37857.310	+ 6222.689928	+ 6108.386350
)	859-17	- 152006.836	- 37856.313	+ 6122.771160	+ 6011.018559
)	859-16	- 152006.873	- 37855.313	+ 6018.339249	+ 5909.419668
)	859-15	- 152006.838	- 37854.316	+ 5909.530294	+ 5804.913868
)	859-14	- 152006.736	- 37853.328	+ 5797.472576	+ 5697.456864
)	859-13	- 152006.562	- 37852.332	+ 5682.738336	+ 5585.708352
)	859-12	- 152006.329	- 37851.362	+ 5564.409228	+ 5473.237444
)	859-11	- 152006.037	- 37850.403	+ 5446.272394	+ 5359.300587
)	859-10	- 152005.670	- 37849.475	+ 5326.085010	+ 5246.180575
)	859-9	- 152005.248	- 37848.569	+ 5207.144800	+ 5132.286230
)	859-8	- 152004.774	- 37847.687	+ 5088.768406	+ 5018.961376
)	859-7	- 152004.247	- 37846.833	+ 4971.226689	+ 4906.880742
)	859-6	- 152003.642	- 37846.042	+ 4853.865786	+ 4799.740374
)	859-5	- 152002.975	- 37845.299	+ 4741.174950	+ 4694.878958
)	859-4	- 152002.274	- 37844.591	+ 4632.909926	+ 4591.758225
)	859-3	- 152001.545	- 37843.909	+ 4527.993095	+ 4490.749066
)	859-45	- 152019.207	- 37858.688	+ 5234.260163	+ 5959.472960
)				+190755.006342	+191000.177219
)			ハイ	=	245.170877
)			ズビキ	=	122.585438

36 入タリ

	アノイ	X	Y	(X-X0)*(YN-1-Y0)	(XN-1-X0)*(Y-Y0)
)	X0.Y0	- 151800.000	- 37800.000		
)	859-36	- 151867.037	- 37811.103		
)	859-37	- 151869.529	- 37812.654	+ 771.980487	+ 848.286198
)	859-38	- 151868.260	- 37808.364	+ 863.762040	+ 581.540556
)	859-36	- 151867.037	- 37811.103	+ 560.697468	+ 757.890780
)				+ 2196.439995	+ 2187.717534
)			ハイ	=	8.722461
)			ズビキ	=	4.361230

59 BLOCK

前 青江 503-1 番地

後 青江 503-1 番地 → 217.61 m²

青江 503-3 番地 → 244.23 m²

59 BLOCK

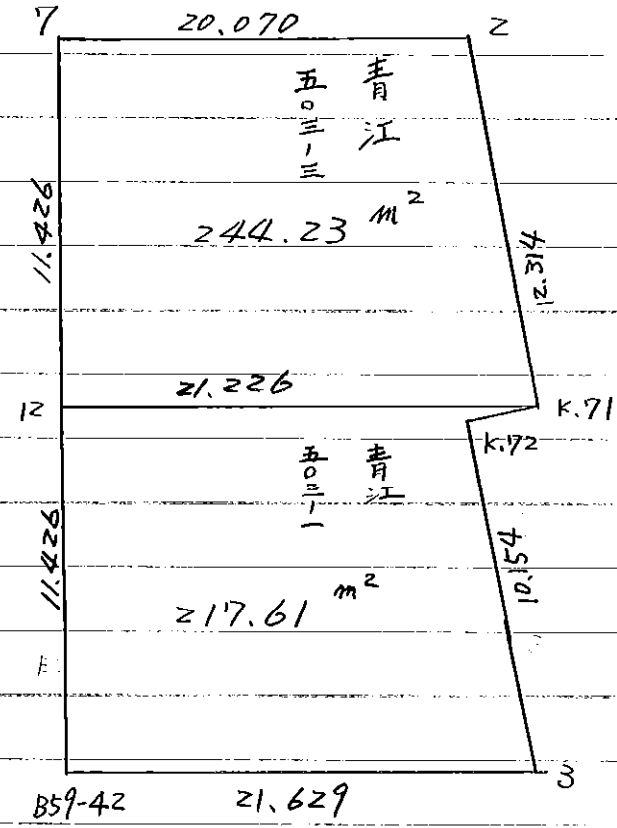

元NO.	X	Y	(X-X ₀)(Y _{N-1} -Y ₀)	(X _{N-1} -X ₀)(Y-Y ₀)
X ₀ ,Y ₀ =	0.000	-9.700		
3-1 LOT				

元NO.	X	Y	(X-X ₀)(Y _{N-1} -Y ₀)	(X _{N-1} -X ₀)(Y-Y ₀)
X ₀ ,Y ₀ =	-151900.000	-37800.000		
7	-151919.843	-37842.207		
2	-151930.428	-37825.155	1284.274596	499.150665
71	-151941.441	-37830.665	1042.448355	933.074620
12	-151929.544	-37848.244	905.966760	1999.279604
7	-151919.843	-37842.207	957.305692	1246.963608
			4189.995403	4678.468497
			メソセキ=	488.473094
			メソセキ=	244.236547

3-2 LOT

元NO.	X	Y	(X-X ₀)(Y _{N-1} -Y ₀)	(X _{N-1} -X ₀)(Y-Y ₀)
X ₀ ,Y ₀ =	-151900.000	-37800.000		
12	-151929.544	-37848.244		
71	-151941.441	-37830.665	1999.279604	905.966760
72	-151940.652	-37834.142	1246.593580	1414.878622
3	-151950.652	-37835.906	1729.360584	1459.650712
42	-151939.244	-37854.282	1409.095064	2749.491864
12	-151929.544	-37848.244	1603.707408	1893.287536
			7988.036240	8423.275494
			メソセキ=	435.239254
			メソセキ=	217.619627